

Township 1° 48' N. Range 1° 37' W. Mer. Mich.

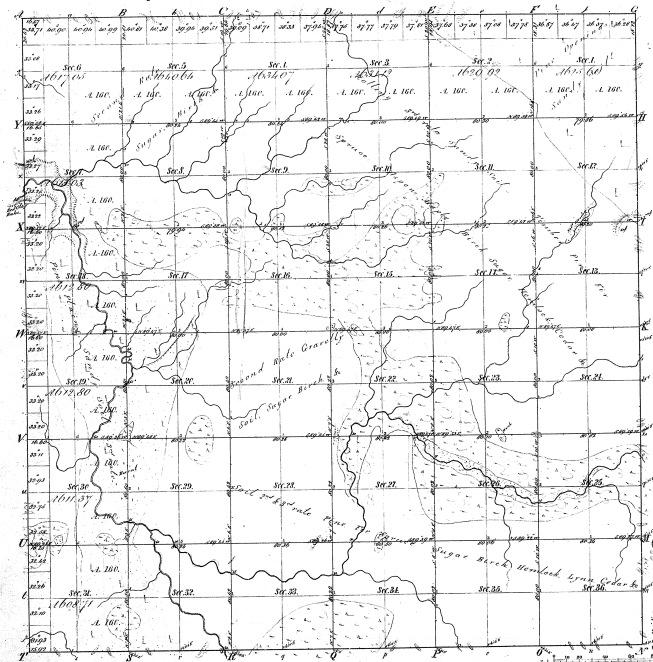

Measure of
Feet (Course 1814) (Feet Course 1814) (Feet Course 1814)

43-13

43-13

Total number of Acres 22837.90

| Survey Designated | By Whom Surveyed | Date of Landset | Amount of Survey | When Surveyed | When Made and by Whom |
|-------------------|------------------|-----------------|------------------|---------------|-----------------------|
| Township Area | John Macel | April 21 1847 | 22,837.90 | 1847 | 1847 |
| Subdivisions | Adrian Clarke | April 16 1861 | 49.67 | 1861 | 1861 |

The above Map of Township 1° 48' North of Range 1° 37' West of the Principal Meridian Michigan is a true and correct copy of the survey thereof on file in this Office which have been examined and approved.

Register Township Office
Detroit, Dec. 24 1882

Charles J. P. P.
Sur. Gen.