

Township 1° 49' N. Range 1° 36' W. Mer. Mich.

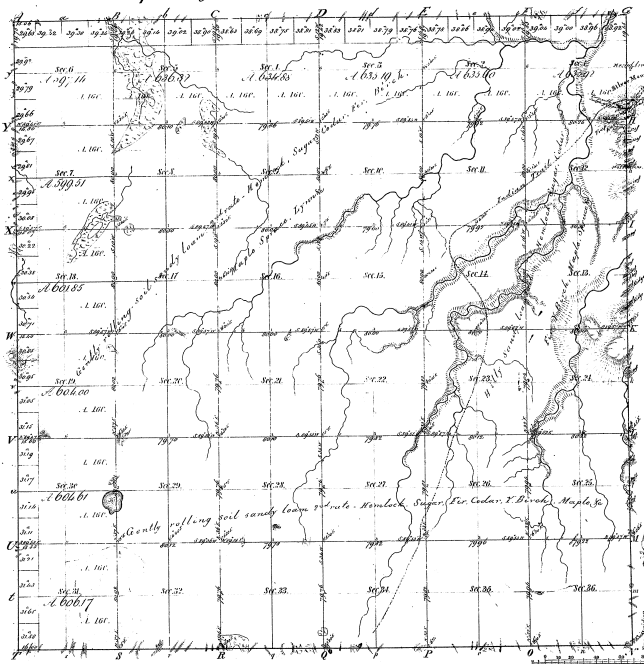

Boundaries of
 1842' Pre-1842' Pre-1842' Pre-1842' Pre-1842'

44-8

44-8

Total number of Acres 22,701.10

Survey designated	By Whom Surveyed	Date of Contract	Amount of Survey	When Surveyed	Plan Filed and when the Survey was completed
Township lines	W. H. Beardslee	April 21, 1857	36 32 1/2	1857	3rd June 1861
Subdivisions	Adrianus Covert	April 21, 1857	29, 28, 28	1857	3rd June 1861

The above map of Township 1° 49' North of Range 1° 36' West of the Principal Meridian Michigan is a study of the original survey of the township as filed in this office which has been examined and approved.

In Surveyor General's Office,
 Detroit, Mich. 25/1872

Charles F. Bollen
 Surveyor General