

Township 1° 45' N Range 1° 37' W Mer. Mich.

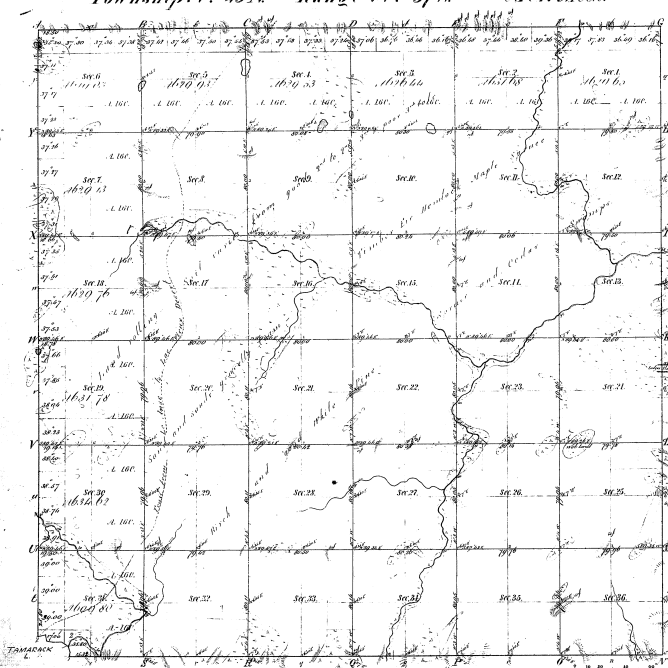

Sections of	Acres	Sections of	Acres
1-36	1135.24		
Meridian & Distance			

43-24

Total number of Acres 29001.35

Survey designated	By whom surveyed	Date of Contract	Amount of Survey	When Surveyed	Time of day and at what the Survey was made
Township 1° 45' N Range 1° 37' W	W. W. Woodruff	April 22, 1857	11, 36, 35	1857	
Subdivisions	Clara C. Martin	May 22, 1857	60, 26, 32	1857	

The above Map of Township 1° 45' North of Range 1° 37' West of the Principal Meridian Michigan is strictly conformable to the full notes of the survey thereon on file in this office which have been examined and approved.

Surveyor General's Office  
 Detroit Jan 22 1858  
 James A. Bell  
 Surveyor