

TOWNSHIP No. 46 NORTH, RANGE No. 37 WEST, MICHIGAN MERIDIAN, MICHIGAN.

PLAT OF AN ISLAND IN "LAKE 33", SEC. 33.

43-2
43-28-3

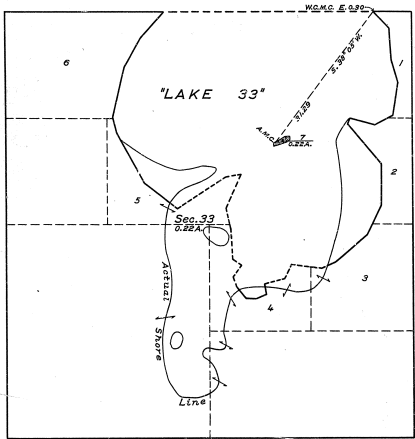

MEMORANDUM.

THIS PLAT REPRESENTS THE SURVEY OF AN ISLAND IN "LAKE 33", WHICH WAS NOT RETURNED AS SURVEYED ON THE TOWNSHIP PLAT APPROVED JANUARY 22, 1853. THE SURVEY WAS EXECUTED PURSUANT TO AUTHORITY CONTAINED IN GENERAL LAND OFFICE LETTER 1109430 "B", DATED NOVEMBER 22, 1925, BEARING DEPARTMENTAL APPROVAL UNDER DATE OF NOVEMBER 24, 1928.

LEGEND.

SCALE: 10 CHAINS TO AN INCH.

SURVEYED BY ROBERT W. LIVINGSTON, U. S. CADASTRAL ENGINEER, FROM SEPTEMBER 14 TO 16, 1929, UNDER SPECIAL INSTRUCTIONS FOR GROUP NO. 19, MICHIGAN, DATED JULY 15, 1929, ISSUED BY THE TECHNICAL ASSISTANT TO THE SUPERVISOR OF SURVEYS, WHICH WERE APPROVED BY THE COMMISSIONER OF THE GENERAL LAND OFFICE ON JULY 25, 1929.

AREA OF LANDS SURVEYED, 0.22 ACRES.

OFFICE OF U. S. SUPERVISOR OF SURVEYS.
DENVER, COLORADO, NOVEMBER 5, 1930.

THE ABOVE PLAT OF AN ISLAND IN "LAKE 33" IN SECTION 33, TOWNSHIP No. 46 NORTH, RANGE No. 37 WEST, OF THE MICHIGAN MERIDIAN, IN THE STATE OF MICHIGAN, IS STRICTLY CONFORMABLE TO THE FIELD NOTES OF THE SURVEY THEREOF, WHICH HAVE BEEN EXAMINED AND APPROVED.

Wm. H. Thomas
U. S. SUPERVISOR OF SURVEYS.

DEPARTMENT OF THE INTERIOR.
GENERAL LAND OFFICE.

WASHINGTON, D. C., DECEMBER 22, 1930.

THE SURVEY REPRESENTED BY THIS PLAT, HAVING BEEN CORRECTLY EXECUTED IN ACCORDANCE WITH THE REQUIREMENTS OF LAW AND THE REGULATIONS OF THIS OFFICE, IS HEREBY ACCEPTED.

Chas. C. Small
ASSISTANT COMMISSIONER.

PLAT OF AN ISLAND
 IN
 Point Lake,
 Sec. 26, T. 46 N., R. 37 W., Mich. Mer.
 MICHIGAN.

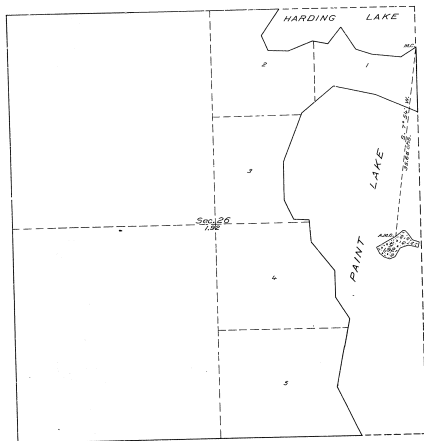

LEGEND.

Scale: 1 inch = 10 chains.

Surveyed by Guy R. Veal, U. S. Geological Engineer, on September 25, 1923, under special instructions for Group No. 1, Michigan, dated May 16, 1923, issued by Frank M. Johnson, Supervisor of Surveys, which were approved by the Commissioner of the General Land Office on May 26, 1923.

Area of lands surveyed = 1.92 Acres, not shown upon the original plat approved January 22, 1853.

Areas of previously surveyed lands not shown.

The undersigned hereby certifies that the survey delineated upon this plat has been executed under his general direction and in accordance with the approved special instructions issued pursuant to authority contained in office letter 1046100 Sp. J. H. S., dated January 24, 1923, and that the field notes and the plat of the survey have been carefully verified.

Denver, Colorado.
 June 9, 1924.

Frank M. Johnson
 Supervisor of Surveys.

Department of the Interior,
 General Land Office.

Washington, D. C., January 21, 1925.

The above plat of an Island in Paint Lake in Section 26, Township 46 North, Range 37 West, of the Michigan Meridian, in the State of Michigan, is strictly conformable to the field notes of the survey thereof, on file in this office, which have been examined and approved.

William Gray
 Commissioner and ex officio
 U. S. Surveyor General for Michigan.

43-23