

776. 13-677

Township 1° 13' N., Range 1° 4' West Mer. (Mich.)

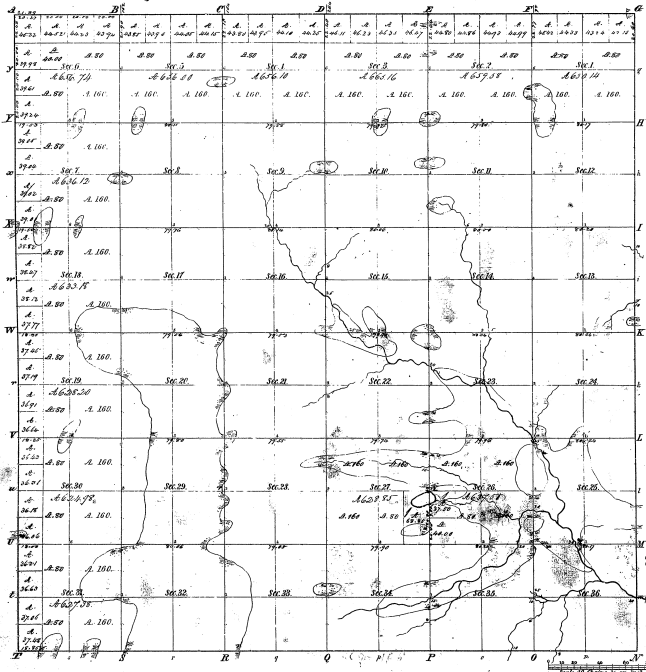

Mentions of a Sale in Volume 22827			
Tract	Course	Tract	Course
1	1/2 Sec 1	1	1/2 Sec 1
2	1/2 Sec 2	2	1/2 Sec 2
3	1/2 Sec 3	3	1/2 Sec 3
4	1/2 Sec 4	4	1/2 Sec 4
5	1/2 Sec 5	5	1/2 Sec 5
6	1/2 Sec 6	6	1/2 Sec 6
7	1/2 Sec 7	7	1/2 Sec 7
8	1/2 Sec 8	8	1/2 Sec 8
9	1/2 Sec 9	9	1/2 Sec 9
10	1/2 Sec 10	10	1/2 Sec 10
11	1/2 Sec 11	11	1/2 Sec 11
12	1/2 Sec 12	12	1/2 Sec 12
13	1/2 Sec 13	13	1/2 Sec 13
14	1/2 Sec 14	14	1/2 Sec 14
15	1/2 Sec 15	15	1/2 Sec 15
16	1/2 Sec 16	16	1/2 Sec 16
17	1/2 Sec 17	17	1/2 Sec 17
18	1/2 Sec 18	18	1/2 Sec 18
19	1/2 Sec 19	19	1/2 Sec 19
20	1/2 Sec 20	20	1/2 Sec 20
21	1/2 Sec 21	21	1/2 Sec 21
22	1/2 Sec 22	22	1/2 Sec 22
23	1/2 Sec 23	23	1/2 Sec 23
24	1/2 Sec 24	24	1/2 Sec 24
25	1/2 Sec 25	25	1/2 Sec 25
26	1/2 Sec 26	26	1/2 Sec 26
27	1/2 Sec 27	27	1/2 Sec 27
28	1/2 Sec 28	28	1/2 Sec 28
29	1/2 Sec 29	29	1/2 Sec 29
30	1/2 Sec 30	30	1/2 Sec 30
31	1/2 Sec 31	31	1/2 Sec 31
32	1/2 Sec 32	32	1/2 Sec 32
33	1/2 Sec 33	33	1/2 Sec 33
34	1/2 Sec 34	34	1/2 Sec 34
35	1/2 Sec 35	35	1/2 Sec 35
36	1/2 Sec 36	36	1/2 Sec 36

13-29

Total number of Acres 2379.93

Survey designated	By whom surveyed	Date of Contract	Amount of Survey	When Surveyed	When for sale or in the hands of the State
Township lines	W. H. Wood	Jan 10, 1837	36 Secs	1837	1837
Subdivisions	W. H. Wood	Jan 10, 1837	36 Secs	1837	1837
Section lines	W. H. Wood	Jan 10, 1837	36 Secs	1837	1837

The above Map of Township 13 N. of Range 1 W. of Mer. is already registered in the office of the surveyor general for this office, which has been examined and approved.

Surveyor General's Office  
 Grand Rapids, Mich. 20th Nov 1839

C. J. Cleaves, Secy