

Township N. 8 N., Range N. 12 West Mer. (Mich.)

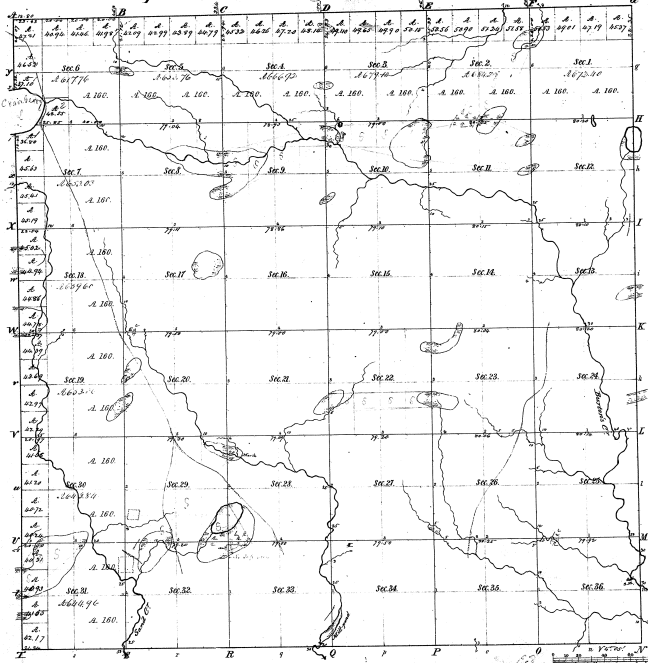

Total number of Acres 33,222.01

Survey designated	By Whom Surveyed	Date of Contract	Amount of Survey	When Surveyed	Range (to and from the Sec. Cont.)
Township - 3600	A. J. ...	...	...	...	...
Subdivisions	...	...	...	...	...

The above Map of Township N. 8 North, of Range N. 12 West of the Principal Meridian, Michigan, is truly conformable to the field notes of the survey thereof on file in this Office which have been examined and approved.

Surveyor General's Office,  
Lansing, Mich. 25, 1838

Meanders of a part of a Lake in Section 6 & 7

Point	Course	Dist	Point	Course	Dist	Point	Course	Dist
1.	N 75° 00' E	2.50						
	N 80° 00' E	1.00						
	N 85° 00' E	1.00						
	N 90° 00' E	1.00						
	N 95° 00' E	1.00						
	N 100° 00' E	1.00						
	N 105° 00' E	1.00						
	N 110° 00' E	1.00						
	N 115° 00' E	1.00						
	N 120° 00' E	1.00						
	N 125° 00' E	1.00						
	N 130° 00' E	1.00						
	N 135° 00' E	1.00						
	N 140° 00' E	1.00						
	N 145° 00' E	1.00						
	N 150° 00' E	1.00						
	N 155° 00' E	1.00						
	N 160° 00' E	1.00						
	N 165° 00' E	1.00						
	N 170° 00' E	1.00						
	N 175° 00' E	1.00						
	N 180° 00' E	1.00						
	N 185° 00' E	1.00						
	N 190° 00' E	1.00						
	N 195° 00' E	1.00						
	N 200° 00' E	1.00						
	N 205° 00' E	1.00						
	N 210° 00' E	1.00						
	N 215° 00' E	1.00						
	N 220° 00' E	1.00						
	N 225° 00' E	1.00						
	N 230° 00' E	1.00						
	N 235° 00' E	1.00						
	N 240° 00' E	1.00						
	N 245° 00' E	1.00						
	N 250° 00' E	1.00						
	N 255° 00' E	1.00						
	N 260° 00' E	1.00						
	N 265° 00' E	1.00						
	N 270° 00' E	1.00						
	N 275° 00' E	1.00						
	N 280° 00' E	1.00						
	N 285° 00' E	1.00						
	N 290° 00' E	1.00						
	N 295° 00' E	1.00						
	N 300° 00' E	1.00						
	N 305° 00' E	1.00						
	N 310° 00' E	1.00						
	N 315° 00' E	1.00						
	N 320° 00' E	1.00						
	N 325° 00' E	1.00						
	N 330° 00' E	1.00						
	N 335° 00' E	1.00						
	N 340° 00' E	1.00						
	N 345° 00' E	1.00						
	N 350° 00' E	1.00						
	N 355° 00' E	1.00						
	N 360° 00' E	1.00						

7-9