

Township. 10 N. Range. 11 West Mer. (Mich)

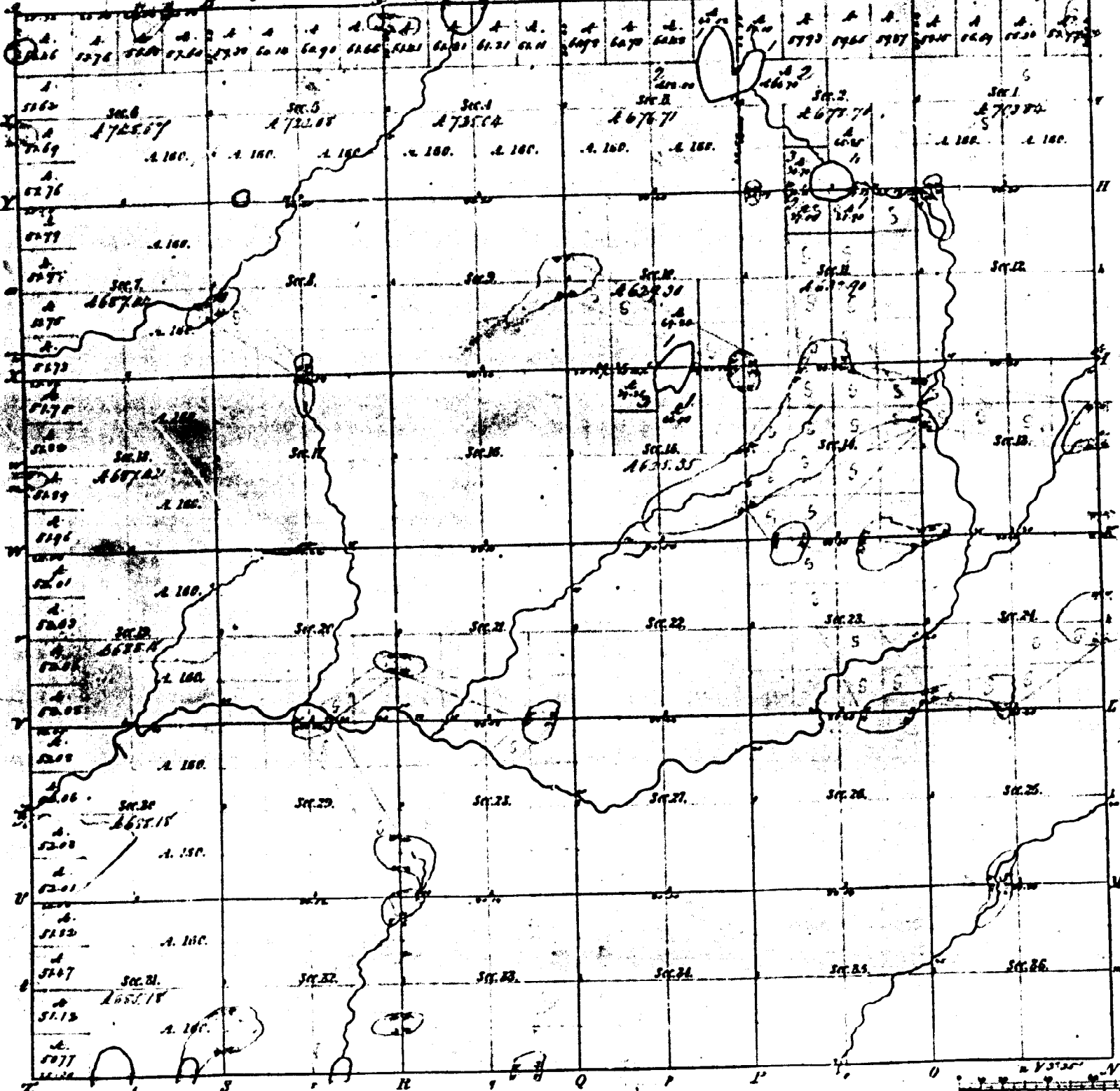

Members of Lakes			
Field	Course	Dist.	Field
Lake in Sec. 29			
2	756	10.00	
	776	10.00	
	788	6.00	
	788	7.00	
	777	3.00	
	759	3.00	
	726	3.00	
Lake in Sec. 23			
2	759	12.00	
	759	10.00	
	719	12.00	
	738	10.00	
	6.00	6.00	
	112	10.00	
	6.00	6.00	
1	738	3.00	
	725	9.00	
	778	6.00	
	758	3.00	
	711	12.00	
	769	9.00	
2	769	1.50	
Lake in Sec. 16			
6	788	12.00	
	778	3.00	
	788	3.00	
	788	10.00	
6	788	1.00	
	759	12.00	
	788	6.00	
	779	3.00	
	788	10.00	
	788	1.50	

7-2

7-2

Total number of Acres 33,658.19

Survey Designated	By Whom Surveyed	Date of Contract	Amount of Survey	When Surveyed	When 1/2 Sec. and 1/4 on the Sec. Com. to sec.
Township lines	N. J. Seabright	Oct. 31. 1836	36. 36. 36	2. 7. 1837	5. 7. 1837
Subdivisions	Chas. A. Belmont	March 1. 1837	6. 14. 37	2. 7. 1837	1. 7. 1837

The above Rep. of Township 10 N. of Range 11 W. of the Principal Meridian Michigan is strictly conformable to the field notes of the survey there on file in this Office which have been examined and approved.

Surveyor General's Office
Cincinnati Feb. 29. 1839

E. S. Jones
Sur. Gen.