

Township N° 58 N. Range N° 26 W.
Manitou Is^d

Mer. Mich.

40-20

40-20

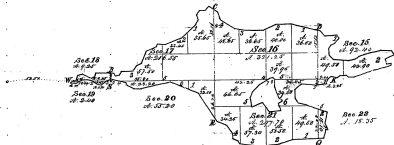

The island just off Harmer point and lying southeast with it, is a continuation of the series of small rocks forming the backbone of the shore. It is however, a solid bar that lies from the east of the lake. The western of the island is not rocky, but a succession of steep ascents to the north, then short abrupt descents of 5 or 8 feet. The land on the west has a surface of rocks and fragments of rocks, covered with moss and ferns. The rock is principally conglomerate; in many places it nearly loses its conglomerate appearance and has an appearance approaching argillaceous shales. In many places thin fern stems and rotten layers of conglomerate. The highest portion of the conglomerate is a horizontal ledge on the east, it is about 35 or 40 feet high. No other portions are more than 15 feet.

| Number of | | Number of | | Number of | |
|-----------|---------|-----------|---------|-----------|---------|
| Pages | Columns | Pages | Columns | Pages | Columns |
| | | | | | |
| | | | | | |
| | | | | | |
| | | | | | |
| | | | | | |
| | | | | | |
| | | | | | |
| | | | | | |
| | | | | | |
| | | | | | |
| | | | | | |
| | | | | | |
| | | | | | |
| | | | | | |
| | | | | | |
| | | | | | |
| | | | | | |
| | | | | | |
| | | | | | |
| | | | | | |
| | | | | | |
| | | | | | |
| | | | | | |
| | | | | | |
| | | | | | |
| | | | | | |
| | | | | | |
| | | | | | |
| | | | | | |
| | | | | | |
| | | | | | |
| | | | | | |
| | | | | | |

Total number of Acres 16-3-10

| Survey designed | By Whom Surveyed | Date of Closure | Amount of Survey | When Surveyed | When Closed in |
|-----------------|------------------|-----------------|----------------------|---------------|----------------|
| Township | | | | | |
| Subdivisions | E. Harmer Is. | June 25 1866 | 11.66 sq. 5.26 Acres | | |

The above, Map of Township N° 58 North, of Range N° 26 West of the Principal Meridian, being more or less conformable to the field notes of the survey hereon filed in the Office, and has been examined and approved
 Surveyor General's Office
 Detroit, May 8. 1866
 Leucus Egan, Secy. Genl