



PLAT OF AN ISLAND  
IN THE ISLE ROYALE GROUP IN LAKE SUPERIOR.

in Sec. 11, T.65N., R.36 W., Michigan Mer.

MICHIGAN.

Surveyed by Francis W. DuBois and Francis F. McKinney, U.S. Transf. Men, Aug. 6, 1914,  
under special instructions from the Com. of the G.L.O., bearing date May 27, 1914.

Scale, 10 chs. to an inch

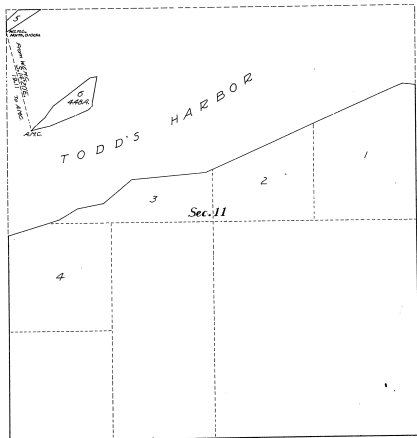

Area of lands surveyed—446 acres, not shown upon the plat approved July 17, 1915.  
Areas of previously surveyed lands not shown.

40-9  
40-9

Department of the Interior,  
General Land Office,  
Washington, D.C., May 24, 1915.  
The above plat of an island in the Isle Royale group, in Lake Superior, in Sec. 11, T.65N., R.36 W., Mich. Mer., Michigan, is strictly conformable to the field notes of the survey thereof on file in this office which have been examined and approved.

Commissioner and ex officio  
U.S. Surveyor General for Michigan.