

Resurvey

Township 1° 28' N

Range 1° 13'

Mer. Mich.

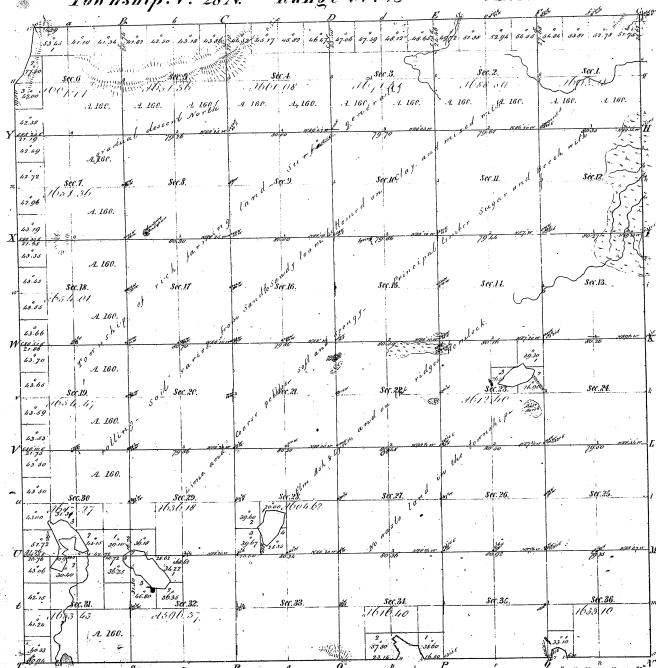

Boundaries of
Public Courses (West) Public Courses (East) Public Courses (West)

11-8

17-8

Total number of Acres 83,043.91

Survey designated	By whom surveyed	Date of Contract	Amount of Survey	When surveyed	Amount in original the Sur. Con. was
Township 1 st 28' N	Self	Jan. 26, 1850	83,043.91	1850	83,043.91
Subdivisions	George Washburn	Jan. 26, 1850	83,043.91	1850	83,043.91
Subdivisions	George Washburn	Jan. 26, 1850	83,043.91	1850	83,043.91

The above map of Township 1° 28' North of Range 1° 13' West of the Principal Meridian Michigan is truly and correctly surveyed and approved by the Surveyors General of the State of Michigan.
Charles Hoff
Sur. Gen.
Eden, Mich. Feb. 21, 1861