

Township 1<sup>o</sup> 48' N Range 1<sup>o</sup> 12' W Mer. Mich.

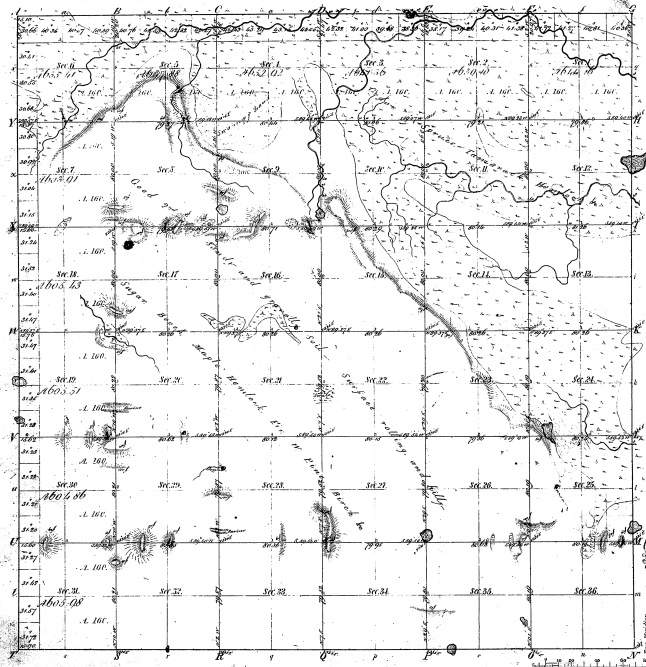

Total number of Acres 22854.59

Survey designated	By whom surveyed	Date of Contract	Amount of Survey	When Surveyed
Township 1 <sup>o</sup> 48' N Range 1 <sup>o</sup> 12' W	A. H. H. H.	April 1 <sup>st</sup> 1857	22854.59	1857
Subdivisions	Francis Coleman	April 9 <sup>th</sup> 1857	59 65.33	1857

The above map of Township 1<sup>o</sup> 48' North of Range 1<sup>o</sup> 12' West of the Principal Meridian Michigan was a duly and lawfully made of the survey being in full to this effect which have been examined and approved by the Surveyor General of the State of Michigan  
 Charles H. Allen  
 Surveyor General

Boundaries of			
North	East	South	West
36-12			