

Mich.

Township 1° 45' N. Range N° 5 W. Mer. Mich.

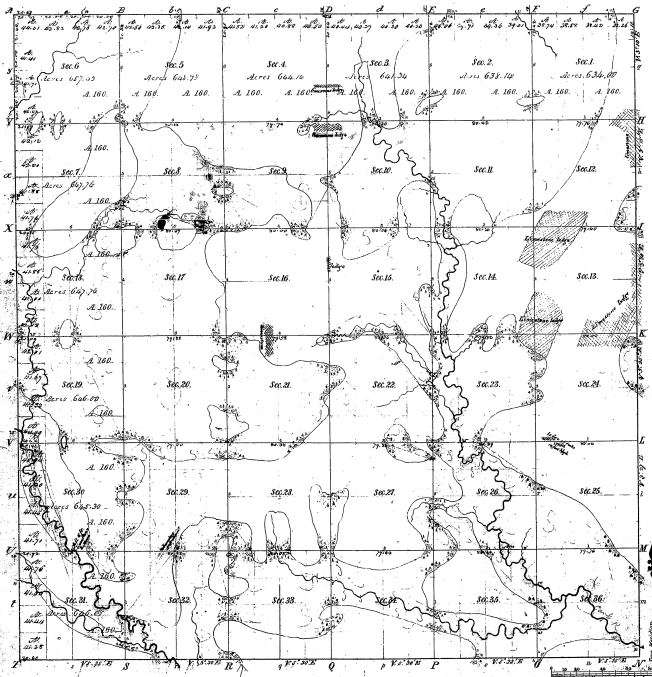

Meanders of

Point Course 1824-31 Point Course 1822 Point Course 1824

24-31

24-37

17-24  
18-27  
28-1  
30

Total number of Acres 23,076.24

Survey designated	By Whom Approved	Date of Contract	Amount of Survey	When Surveyed	Amount for and set off to the Surveyor's Use
Township Survey	Wm. M. Mearns	April 17, 1824	Ac. 23,076.24	2-11-24	
Subdivisions	Chas. C. L. Pugh	April 2, 1825	Ac. 23,076.24	2-11-25	

The above Map of Township 1° 45' North of Range N° 5 West of the Principal Meridian Michigan is duly compared to the field notes of the survey kept on file in this Office, and has been pronounced correct according to the Surveyors Office  
 Detroit, this 12<sup>th</sup> 1845  
 Geo. W. Logan, Sur. Genl.