

Township N^o. 21 North, Range N^o. 15 West Mer. (Mich.)

1736
21-16
1736

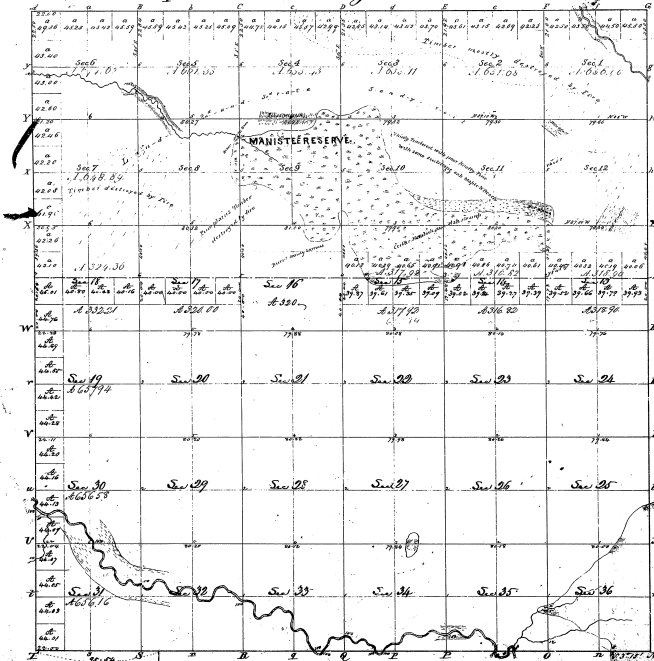

The above is a copy of the Survey of the Township of Manistee, Michigan, as shown on the original plat of the Survey of the Township of Manistee, Michigan, which is on file in this office, which has been examined and approved.

To charge hands of the Public March 16 1853

Successors of the Surveyor

Survey	Plat	Section	Area	Remarks
9719.08	1226.60	36	36.00	Manistee Reserve
9719.08	1226.60	35	35.00	Manistee Reserve
9719.08	1226.60	34	34.00	Manistee Reserve
9719.08	1226.60	33	33.00	Manistee Reserve
9719.08	1226.60	32	32.00	Manistee Reserve
9719.08	1226.60	31	31.00	Manistee Reserve
9719.08	1226.60	30	30.00	Manistee Reserve
9719.08	1226.60	29	29.00	Manistee Reserve
9719.08	1226.60	28	28.00	Manistee Reserve
9719.08	1226.60	27	27.00	Manistee Reserve
9719.08	1226.60	26	26.00	Manistee Reserve
9719.08	1226.60	25	25.00	Manistee Reserve
9719.08	1226.60	24	24.00	Manistee Reserve
9719.08	1226.60	23	23.00	Manistee Reserve
9719.08	1226.60	22	22.00	Manistee Reserve
9719.08	1226.60	21	21.00	Manistee Reserve
9719.08	1226.60	20	20.00	Manistee Reserve
9719.08	1226.60	19	19.00	Manistee Reserve
9719.08	1226.60	18	18.00	Manistee Reserve
9719.08	1226.60	17	17.00	Manistee Reserve
9719.08	1226.60	16	16.00	Manistee Reserve
9719.08	1226.60	15	15.00	Manistee Reserve
9719.08	1226.60	14	14.00	Manistee Reserve
9719.08	1226.60	13	13.00	Manistee Reserve
9719.08	1226.60	12	12.00	Manistee Reserve
9719.08	1226.60	11	11.00	Manistee Reserve
9719.08	1226.60	10	10.00	Manistee Reserve
9719.08	1226.60	9	9.00	Manistee Reserve
9719.08	1226.60	8	8.00	Manistee Reserve
9719.08	1226.60	7	7.00	Manistee Reserve
9719.08	1226.60	6	6.00	Manistee Reserve
9719.08	1226.60	5	5.00	Manistee Reserve
9719.08	1226.60	4	4.00	Manistee Reserve
9719.08	1226.60	3	3.00	Manistee Reserve
9719.08	1226.60	2	2.00	Manistee Reserve
9719.08	1226.60	1	1.00	Manistee Reserve

The above is a copy of the Survey of the Township of Manistee, Michigan, as shown on the original plat of the Survey of the Township of Manistee, Michigan, which is on file in this office, which has been examined and approved.