

Township N. 22 N., Range N. 4 West Mer. (Mich.)

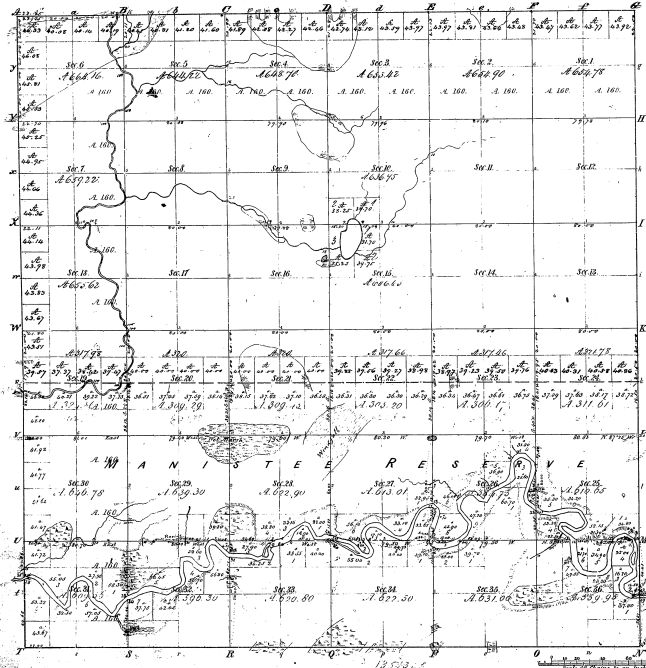

Total number of Acres 13,553.6

Survey Designated	By Whom Surveyed	Date of Contract	Amount of Survey	When Surveyed	Proved and set out per Acre	Per Acre
Section 36	John R. Co. & Co.	1st of 1836	4, 91, 45	6 th 1837	3 1/2	10M
Section 35	John R. Co. & Co.	1st of 1836	4, 91, 45	6 th 1837	3 1/2	10M
Section 34	P. Weston	4th of 1841	47, 44, 46	2 nd of 1842	3 1/2	10M

The above copy of Township N. 22 North of Range N. 4 West of the Principal Meridian Michigan was duly surveyed and approved of the surveyors of the same and approved by the Surveyor General of Michigan Aug. 12th 1843

Measurements of a Park in Sections 35 & 36			
Section	Perch	Perch	Perch
35	100.00	100.00	100.00
36	100.00	100.00	100.00
37	100.00	100.00	100.00
38	100.00	100.00	100.00
39	100.00	100.00	100.00
40	100.00	100.00	100.00
41	100.00	100.00	100.00
42	100.00	100.00	100.00
43	100.00	100.00	100.00
44	100.00	100.00	100.00
45	100.00	100.00	100.00
46	100.00	100.00	100.00
47	100.00	100.00	100.00
48	100.00	100.00	100.00
49	100.00	100.00	100.00
50	100.00	100.00	100.00
51	100.00	100.00	100.00
52	100.00	100.00	100.00
53	100.00	100.00	100.00
54	100.00	100.00	100.00
55	100.00	100.00	100.00
56	100.00	100.00	100.00
57	100.00	100.00	100.00
58	100.00	100.00	100.00
59	100.00	100.00	100.00
60	100.00	100.00	100.00

This copy of part of the Township N. 22 North of Range N. 4 West of the Principal Meridian Michigan was duly surveyed and approved of the surveyors of the same and approved by the Surveyor General of Michigan Aug. 12th 1843

Surveyed by

Approved by

Surveyor General of Michigan

17-32

