

Township N. 25 N. Range N. 10 W. Mer.

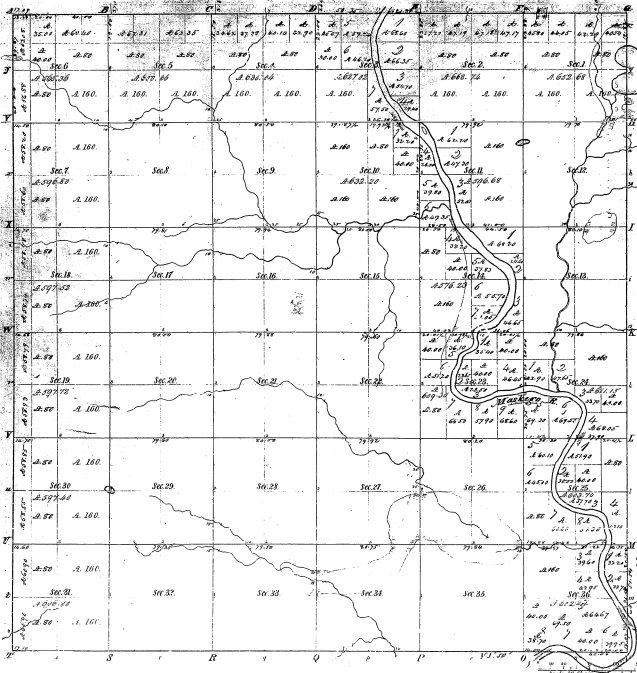

Boundaries of Township

Section	Acres	Section	Acres	Section	Acres
30.1	360.00	30.11	360.00	30.21	360.00
30.2	360.00	30.12	360.00	30.22	360.00
30.3	360.00	30.13	360.00	30.23	360.00
30.4	360.00	30.14	360.00	30.24	360.00
30.5	360.00	30.15	360.00	30.25	360.00
30.6	360.00	30.16	360.00	30.26	360.00
30.7	360.00	30.17	360.00	30.27	360.00
30.8	360.00	30.18	360.00	30.28	360.00
30.9	360.00	30.19	360.00	30.29	360.00
30.10	360.00	30.20	360.00	30.30	360.00
30.11	360.00	30.21	360.00	30.31	360.00
30.12	360.00	30.22	360.00	30.32	360.00
30.13	360.00	30.23	360.00	30.33	360.00
30.14	360.00	30.24	360.00	30.34	360.00
30.15	360.00	30.25	360.00	30.35	360.00
30.16	360.00	30.26	360.00		
30.17	360.00	30.27	360.00		
30.18	360.00	30.28	360.00		
30.19	360.00	30.29	360.00		
30.20	360.00	30.30	360.00		
30.21	360.00	30.31	360.00		
30.22	360.00	30.32	360.00		
30.23	360.00	30.33	360.00		
30.24	360.00	30.34	360.00		
30.25	360.00	30.35	360.00		
30.26	360.00				
30.27	360.00				
30.28	360.00				
30.29	360.00				
30.30	360.00				
30.31	360.00				
30.32	360.00				
30.33	360.00				
30.34	360.00				
30.35	360.00				

Total number of Acres 21600.00

Survey	By whom surveyed	Date of contract	Amount of survey	When surveyed	How surveyed
1	John C. Lutz	10/10/1837	30.30	1837	3/4 1/2 1/2 3/4
2	J. C. Lutz	10/25/1837	71.70	1838	1/4 1/2 1/2 3/4

The above map of Township N. 25 North of Range 10 West of the Principal Meridian North Dakota is a duly corrected to the field notes of the survey thereon in the office, which have been examined and approved.

Surveyor General of the Territory
 Minnesota, Feb. 25, 1839
 J. C. Lutz

J. C. Lutz

11-22

