

Township. 1° 36' N. Range. 1° 27' W. Mer. Mich.

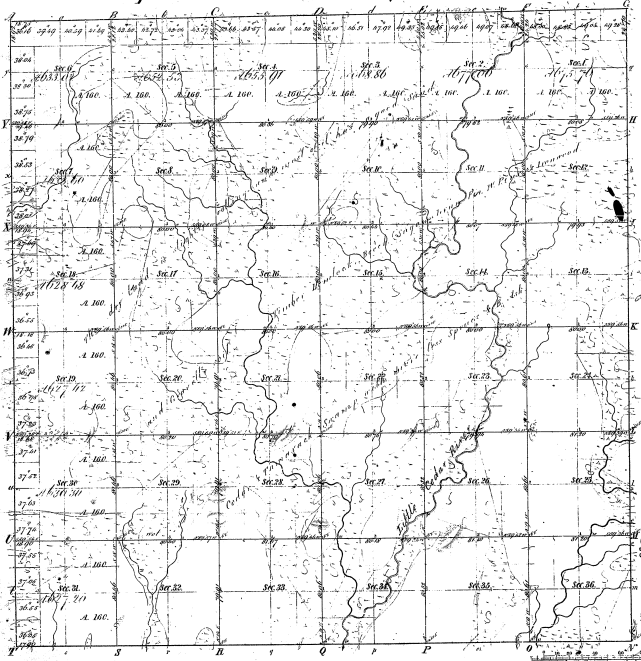

Boundaries of
 1824 Course 1824 Course 1824 Course 1824 Course 1824

47-15

Total number of Acres 23040.44

Survey Designated	By Whom Surveyed	Date of Contract	Amount of Survey	When Surveyed	Where Surveyed
Boundary Survey	John McMillan	June 26, 1857	36 Secs	1857	Michigan
Subdivision	Thomas Colburn	Dec 30, 1858	69 Secs	1858	Michigan

The above map of Township 1° 36' N. Range 1° 27' West of the
 Principal Meridian is a copy of the original map
 of the surveyors in file in the office of the Surveyor General and approved.

Surveyor General of the State
 Robert A. H. 1852

Charles Little

Surveyor

Map corrected 1858