

Township N11 R10E Range N8W one of the (Black Sea)

77

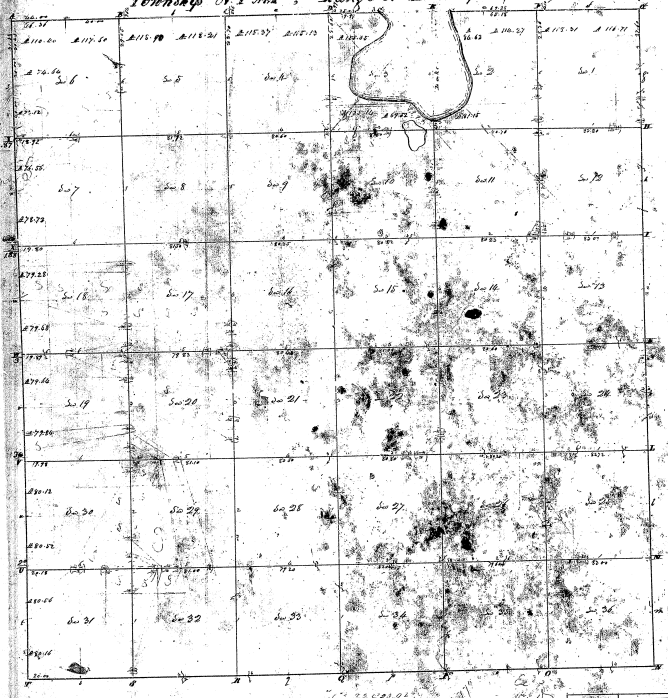

28-37

28-37

Consent to a contract with our intention from David Hoffman Surveyor General of the United States, having seen the  
 plan annexed hereto and surveyed the above described land as well as that it is such as to  
 and bounds both actual and original as are represented on said plat and described in the field notes upon which  
 and returned with the plat to the Surveyor General's office at St. Louis the 10th day of June 1855

J. Wampler Del