

Township N.° 14. North, Range N.° 19 West 4th Mer. (Mid)

9-14

4-1-6

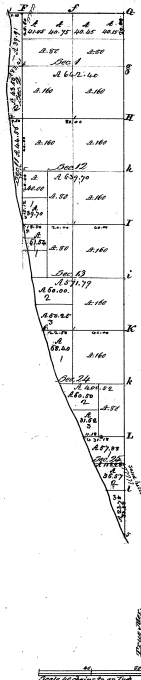

Abstracts of	
S. M. M. M. M.	
S. M. M. M. M.	
1.	1782 1/4 148 1/4
2.	1783 1/4 148 1/4
3.	1784 1/4 148 1/4
4.	1785 1/4 148 1/4
5.	1786 1/4 148 1/4
6.	1787 1/4 148 1/4
7.	1788 1/4 148 1/4
8.	1789 1/4 148 1/4
9.	1790 1/4 148 1/4
10.	1791 1/4 148 1/4
11.	1792 1/4 148 1/4
12.	1793 1/4 148 1/4
13.	1794 1/4 148 1/4
14.	1795 1/4 148 1/4
15.	1796 1/4 148 1/4
16.	1797 1/4 148 1/4
17.	1798 1/4 148 1/4
18.	1799 1/4 148 1/4
19.	1800 1/4 148 1/4
20.	1801 1/4 148 1/4

Lake Michigan.

Total number of Acres 2370.61

Survey	By whom surveyed	Surveyed	Section	Area	When surveyed	Length of year
Section 20	Wm. M. M. M.	1837	1	148 1/4	1837	1838
Section 21	Wm. M. M. M.	1837	1	148 1/4	1837	1838
Section 22	Wm. M. M. M.	1837	1	148 1/4	1837	1838

The above Map of Township N.° 14 North, Range N.° 19 West of the Principal Meridian Michigan is strictly conformable to the field notes of the surveying party on file in this office, which have been examined and approved.  
 Surveyor General Office,  
 Grand Rapids, Aug. 1, 1838  
 P. B. Cairns, Secy.