

Township 1<sup>st</sup> 48<sup>th</sup> N. Range 1<sup>st</sup> 4<sup>th</sup> E. Mer. Mich.

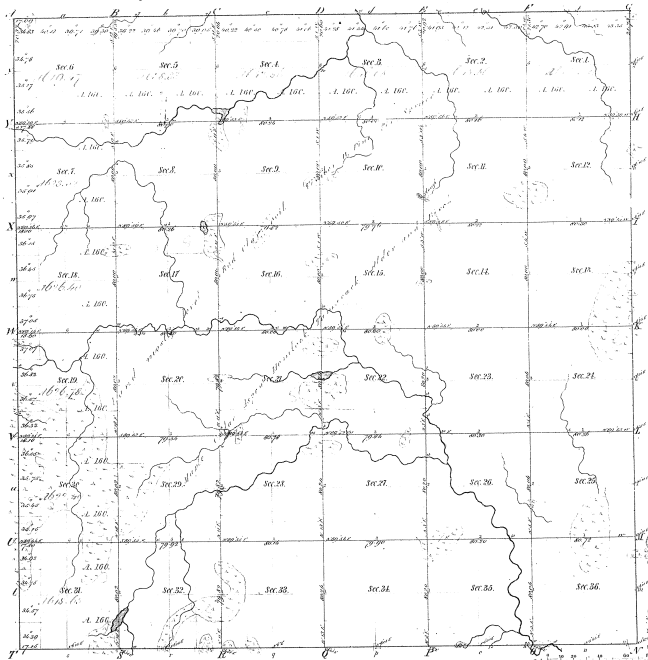

Boundaries of  
 Public Courses 1842<sup>d</sup> Public Courses 1828<sup>d</sup> Public Courses 1854<sup>d</sup>

139

43-9

Total number of Acres 2296.00<sup>d</sup>

Survey designated	By Whom Surveyed	Date of Contract	Amount of Survey	When Surveyed	Plan of the land and all in the Section thereon
Township lines	W. A. Bland	April 27 1857	36 58 46	1857	1 <sup>st</sup> Course 1857
Subdivisions	W. A. Bland	April 28 1857	89 76 00	1857	2 <sup>nd</sup> Course 1857

The above Map of Township 1<sup>st</sup> 48<sup>th</sup> North of Range 1<sup>st</sup> 4<sup>th</sup> East of the Principal Meridian Michigan is truly correct to the full extent of the survey thereon in file in this office, which have been examined and approved.

Surveyor General's Office.  
 Detroit, Dec 5 1857  
 Charles W. Hill  
 Surveyor General