

Township N^o 51 N. Range N^o 44 W.

Mer. Mich.

Lake Superior.

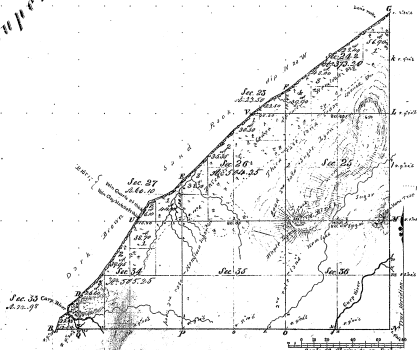

Method of							
Date	Section	Acres	Section	Acres	Section	Acres	Section

Total number of Acres 3409.75

Survey Subjected	By Whom Surveyed	Date of Contract	Amount of Survey	When Surveyed	Price charged on the Survey
Surveyed	By C. B. Buel	March 21st 1857	64 1/2 Secs.	61 st of 1855	
Subdivided	By C. B. Buel	April 21st 1856	16 Secs.	17 th of 1856	

The above Map of Township N^o 51, North of Range N^o 44, W. of the
 Principal Meridian is a true and correct copy of all entries
 of the surveying on file in this office, which have been examined and approved.
 C. B. Buel, Surveyor General
 Detroit, Mich. 16. 1857
 Lucius Lyon, Secy Genl

H1-30