

RESERVE
 Township No 24 N Range No 1 E Mer. Mich.

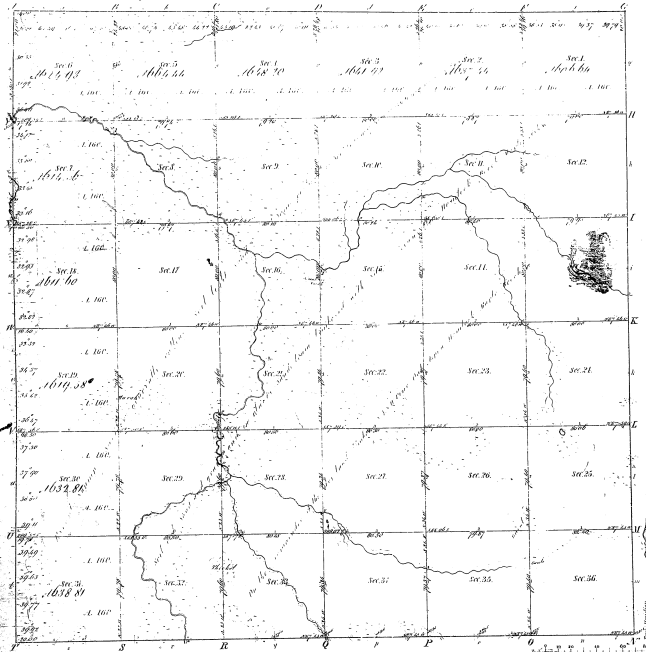

Boundaries of
 Public Lands 1816 Public Lands 1818 Public Lands 1820

14-28

Total number of Acres 22040.93

Survey Discovered	By Whom Discovered	Date of Discovery	Amount of Discovery	When Discovered	Place of the land at the time of discovery
Discovery made	John Brown	Nov 16 1836	2 352 510	1836	1839
Discovery made	William Cook	April 30 1837	2 688 46	1837	1837
			2 000 00		

The above map of Township 24 North Range 1 East of the Principal Meridian Michigan is a faithful representation of the field notes of the survey thereon on file in this office, which have been examined and approved.
 Surveyor General of Mich.
 Detroit June 22 1851
 Charles Chisholm
 Secy