

Township N.º 13 N., Range N.º 5 East

Mer. (Mich.)

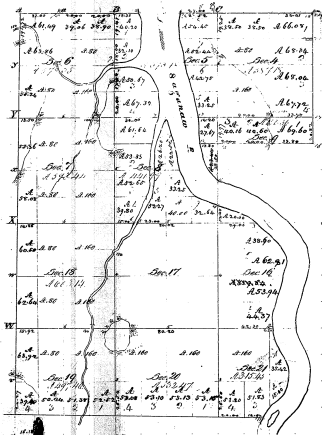

57 2.266

Survey Proposed	By Whom Surveyed	Date of Commencement	Total number of Acres		When Closed in the Survey
			Acres	Perches	
Proposed	J. H.
...

This above plat of Township N.º 13 N., Range N.º 5 East, Michigan, is a true and correct plat of the survey thereof, and is a true and correct copy of the original survey.

John ...
Par ...

Mentions of Subsequent Acquisitions	
Section	Acres
1	...
2	...
3	...
4	...
5	...
6	...
7	...
8	...
9	...
10	...
11	...
12	...
13	...
14	...
15	...
16	...

21
21

24-27-88

7/4 NR 5 E, Cont 3 NR 5 E,

24-27
24-27

988
64-7-10
1888

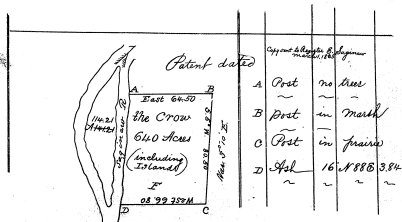

A true copy of the original
Surveyor General's office
May 7th 1823

Edward Duffin

DEPARTMENT OF THE INTERIOR
GENERAL LAND OFFICE,

Washington, D. C. May 7th 1866
I hereby certify that the foregoing is a true
and correct exemplification of the original
plat of survey to which it purports to relate,
now on file in this office.

Acting Commissioner