

Township N. V North Range N. XVI East of Mer. Michigan Territory

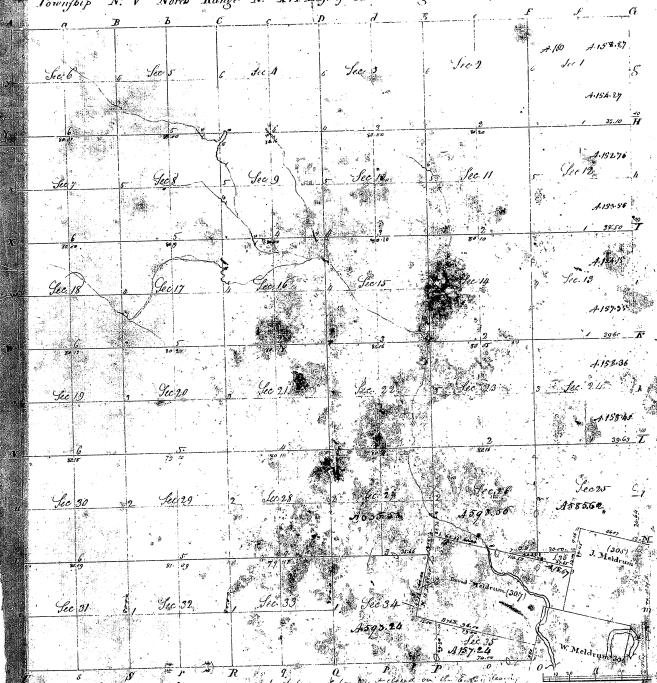

26-27

26-27

Pursuant to a contract with and Instructions from Edward Tiffin Esquire Surveyor Genl of the United States having date the 26th day of Nov 1816 I have administered laid out and surveyed the above described township and its several sections and bounds both natural and artificial as are shown on the plat and described in the field notes made thereof and returned with this Plat into the Surveyors Office at St. Louis this 18th day of Feb 1818

William Patton Sr