

Township N^o 42 N. Range N^o 13 W. Mer. Mich.

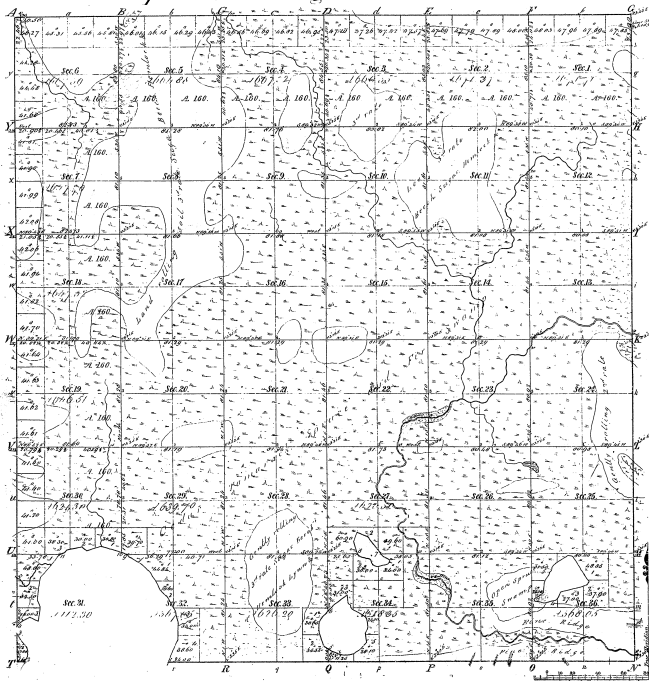

Numbers of
Final Courses 1854 Final Courses 1855 Final Courses 1856

3634

480.9

478.61

478.24

478.07

Total Number of miles square 33.66

36-35

Total number of Acres 217,89.92

Survey assigned	By Whom Surveyed	Date of Contract	Amount of Survey	When Surveyed	How far and what to the Sec. Cont. to
Township lines	J. H. B. & Co.	Feb. 26. 1842	36.36	1842	1/2 Sec. 1842
Subdivisions	Col. H. Carlton	July 26. 1849	66.24.17	1849	1/2 Sec. 1849

The above copy of Township N42 North of Range N13 West of the Principal Meridian Michigan is hereby confirmed to the full extent of the survey except so far as this Office, which have been examined and approved.

Recorder General Office
Detroit Sept. 3. 1856

Charles White Surveyor