

Township N. 7th South, Range N. 7th East of 1st Meridian.

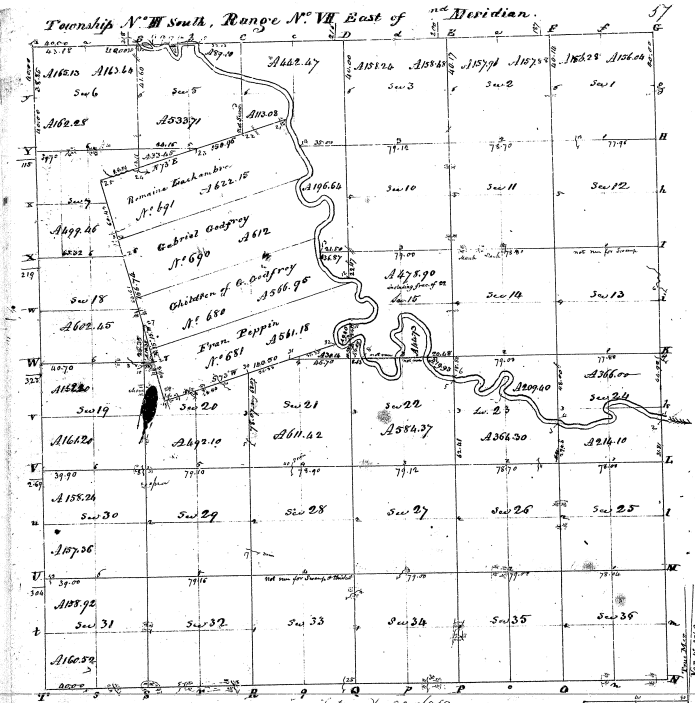

31-14

31-14

Witnessed by 20 661 89
 Passed it to a notary with and instructions from Edmund S. Phipps, Surveyor General of the United States, bearing date the
 day of April 1819. I have administered said oath and occupy the above described township & also hereby certify that the
 said section numbers and bounds both natural and artificial as are represented on said plat and described in the plat were
 found & returned with the plat to the surveyor general's office.

Witnessed this 15th day of September 1819

A. Wampler Secy

Private claims the bonus being set at $3\frac{1}{2}$ c. per
beginning at 20 white oak sapling 6 inches dia situated
on S. side of Hudson thence along old line of claims

N 73 W 90.50 hum 20' E
105.00 enter pt
128.00 left 20' at hum 16' of E
127.00 enter pt
134.63 left 20' at hum 14' of E w.o. 20' with 16'
140.50 old post cor. claims w.o. 20' of 81' W 10'

N 57 1/4 W 25.20 enter sup. at hum 6' East
40.70 old post
7.75 hum 3' of E
39.00 left sup.
41.00 old post
40.00 hum 3' west
42.56 old post
42.88 old post cor. claims (E. 14' of 86' 63'
W. 0.16 of 87' 27' 25')

N 73 E 8.40 hum down same
20.85 left hum 16'
125.10. 1/4 W 11' 48' E
14.6.00 enter pt
150.96 post at river cor. claims no height
417.024 5-17-04

Survey of J. G. Grogan's Trading house on Mason River
in Township N. 3 East, Range N. 7 East.

These bearings were run
out by the Original
Owner.

Scale of 80 chains
to an inch

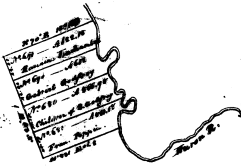

Commencing at the bridge and following thence on the north
border of the river Mason thence cutting across of Francis Robbins
having 1/2 mile thence with his boundary line -
then all
370 W - 120.15 to a first boundary corner thence with the line
180 W - 20.00 to a second corner of 1/2 mile thence then across
a westerly line of 1/2 mile
--- 60.00 to boundary corner of 1/2 mile thence with the boundary line thence
--- 62.00 to boundary corner of 1/2 mile thence with the boundary line thence
--- 62.00 to boundary corner of 1/2 mile thence with the line thence
N 70 E - 100.00 to post on the border of the river Mason N. boundary
corner thereof.