

Township N^o III South, Range N^o IX East of the Mer. (Michigan Ter.)

80

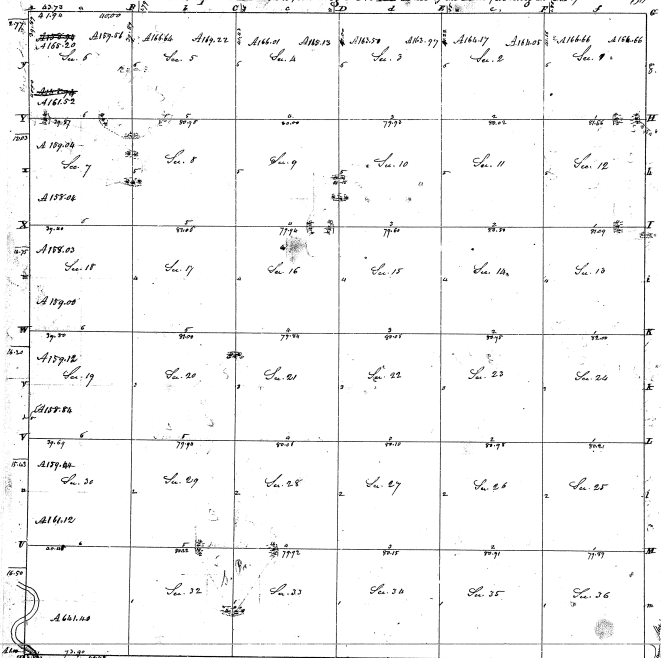

31-12

2-1-12

2330
 I have examined a certain well and returned from Edward J. Ryan, Surveyor General of the United States, I have examined, had not and having the above described land, and as being correct that it did not include any lands, both actual and artificial, as are represented on said plat and returned to the said well and that the return was the true and correct copy of the Surveyor General. Witness my hand and seal this 23rd day of May, 1887.
 J. P. Hatched (P.S.)