

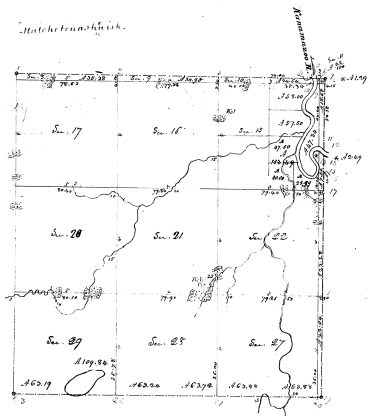

Township 1<sup>st</sup> N. 2<sup>nd</sup> South, Range 1<sup>st</sup> W. 1<sup>st</sup> West Mer. (Mic. Ter.)



Surveyed in June 1889 by Orange Hinton, S.S.

2-5

2-5

Section	Area	Area
17	8	247.38
18	9	301.98
19	10	244.46
20	11	7.59
21	12	18.68
22	13	17.59
23	14	47.16
24	15	20.49
25	16	38.00
26	17	27.59
27	18	115.49
28	19	22.00
29	20	64.00
30	21	64.00
31	22	64.00
32	23	64.00
33	24	64.00
34	25	63.88
35	26	63.88
36	27	63.88
37	28	63.88
38	29	63.88
39	30	63.88
40	31	63.88
41	32	63.88
42	33	63.88
43	34	63.88
44	35	63.88
45	36	63.88
46	37	63.88
47	38	63.88
48	39	63.88
49	40	63.88
50	41	63.88
51	42	63.88
52	43	63.88
53	44	63.88
54	45	63.88
55	46	63.88
56	47	63.88
57	48	63.88
58	49	63.88
59	50	63.88
60	51	63.88
61	52	63.88
62	53	63.88
63	54	63.88
64	55	63.88
65	56	63.88
66	57	63.88
67	58	63.88
68	59	63.88
69	60	63.88
70	61	63.88
71	62	63.88
72	63	63.88
73	64	63.88
74	65	63.88
75	66	63.88
76	67	63.88
77	68	63.88
78	69	63.88
79	70	63.88
80	71	63.88
81	72	63.88
82	73	63.88
83	74	63.88
84	75	63.88
85	76	63.88
86	77	63.88
87	78	63.88
88	79	63.88
89	80	63.88
90	81	63.88
91	82	63.88
92	83	63.88
93	84	63.88
94	85	63.88
95	86	63.88
96	87	63.88
97	88	63.88
98	89	63.88
99	90	63.88
100	91	63.88
101	92	63.88
102	93	63.88
103	94	63.88
104	95	63.88
105	96	63.88
106	97	63.88
107	98	63.88
108	99	63.88
109	100	63.88
110	101	63.88
111	102	63.88
112	103	63.88
113	104	63.88
114	105	63.88
115	106	63.88
116	107	63.88
117	108	63.88
118	109	63.88
119	110	63.88
120	111	63.88
121	112	63.88
122	113	63.88
123	114	63.88
124	115	63.88
125	116	63.88
126	117	63.88
127	118	63.88
128	119	63.88
129	120	63.88
130	121	63.88
131	122	63.88
132	123	63.88
133	124	63.88
134	125	63.88
135	126	63.88
136	127	63.88
137	128	63.88
138	129	63.88
139	130	63.88
140	131	63.88
141	132	63.88
142	133	63.88
143	134	63.88
144	135	63.88
145	136	63.88
146	137	63.88
147	138	63.88
148	139	63.88
149	140	63.88
150	141	63.88
151	142	63.88
152	143	63.88
153	144	63.88
154	145	63.88
155	146	63.88
156	147	63.88
157	148	63.88
158	149	63.88
159	150	63.88
160	151	63.88
161	152	63.88
162	153	63.88
163	154	63.88
164	155	63.88
165	156	63.88
166	157	63.88
167	158	63.88
168	159	63.88
169	160	63.88
170	161	63.88
171	162	63.88
172	163	63.88
173	164	63.88
174	165	63.88
175	166	63.88
176	167	63.88
177	168	63.88
178	169	63.88
179	170	63.88
180	171	63.88
181	172	63.88
182	173	63.88
183	174	63.88
184	175	63.88
185	176	63.88
186	177	63.88
187	178	63.88
188	179	63.88
189	180	63.88
190	181	63.88
191	182	63.88
192	183	63.88
193	184	63.88
194	185	63.88
195	186	63.88
196	187	63.88
197	188	63.88
198	189	63.88
199	190	63.88
200	191	63.88
201	192	63.88
202	193	63.88
203	194	63.88
204	195	63.88
205	196	63.88
206	197	63.88
207	198	63.88
208	199	63.88
209	200	63.88
210	201	63.88
211	202	63.88
212	203	63.88
213	204	63.88
214	205	63.88
215	206	63.88
216	207	63.88
217	208	63.88
218	209	63.88
219	210	63.88
220	211	63.88
221	212	63.88
222	213	63.88
223	214	63.88
224	215	63.88
225	216	63.88
226	217	63.88
227	218	63.88
228	219	63.88
229	220	63.88
230	221	63.88
231	222	63.88
232	223	63.88
233	224	63.88
234	225	63.88
235	226	63.88
236	227	63.88
237	228	63.88
238	229	63.88
239	230	63.88
240	231	63.88
241	232	63.88
242	233	63.88
243	234	63.88
244	235	63.88
245	236	63.88
246	237	63.88
247	238	63.88
248	239	63.88
249	240	63.88
250	241	63.88
251	242	63.88
252	243	63.88
253	244	63.88
254	245	63.88
255	246	63.88
256	247	63.88
257	248	63.88
258	249	63.88
259	250	63.88
260	251	63.88
261	252	63.88
262	253	63.88
263	254	63.88
264	255	63.88
265	256	63.88
266	257	63.88
267	258	63.88
268	259	63.88
269	260	63.88
270	261	63.88
271	262	63.88
272	263	63.88
273	264	63.88
274	265	63.88
275	266	63.88
276	267	63.88
277	268	63.88
278	269	63.88
279	270	63.88
280	271	63.88
281	272	63.88
282	273	63.88
283	274	63.88
284	275	63.88
285	276	63.88
286	277	63.88
287	278	63.88
288	279	63.88
289	280	63.88
290	281	63.88
291	282	63.88
292	283	63.88
293	284	63.88
294	285	63.88
295	286	63.88
296	287	63.88
297	288	63.88
298	289	63.88
299	290	63.88
300	291	63.88
301	292	63.88
302	293	63.88
303	294	63.88
304	295	63.88
305	296	63.88
306	297	63.88
307	298	63.88
308	299	63.88
309	300	63.88
310	301	63.88
311	302	63.88
312	303	63.88
313	304	63.88
314	305	63.88
315	306	63.88
316	307	63.88
317	308	63.88
318	309	63.88
319	310	63.88
320	311	63.88
321	312	63.88
322	313	63.88
323	314	63.88
324	315	63.88
325	316	63.88
326	317	63.88
327	318	63.88
328	319	63.88
329	320	63.88
330	321	63.88
331	322	63.88
332	323	63.88
333	324	63.88
334	325	63.88
335	326	63.88
336	327	63.88
337	328	63.88
338	329	63.88
339	330	63.88
340	331	63.88
341	332	63.88
342	333	63.88
343	334	63.88
344	335	63.88
345	336	63.88
346	337	63.88
347	338	63.88
348	339	63.88
349	340	63.88
350	341	63.88
351	342	63.88
352	343	63.88
353	344	63.88
354</		

T. 2 S. R. 11 W. Mich

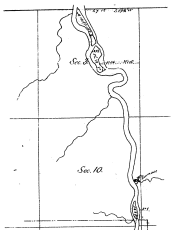

Surveyed in 1880 by Thomas Murphy, Surveyor General

The above diagram of islands in the Kalamazoo  
 River in T. 2 S. R. 11 W. is hereby confirmed with the field  
 notes of the same on file in this office  
 Surveyor General's Office  
 Detroit, August 29 1870  
 Charles H. Hill  
 Surveyor General

2-5

2-5 ③