

Resurvey

Township 1° 44' N. Range 1° 19' W. Mer. Mich.

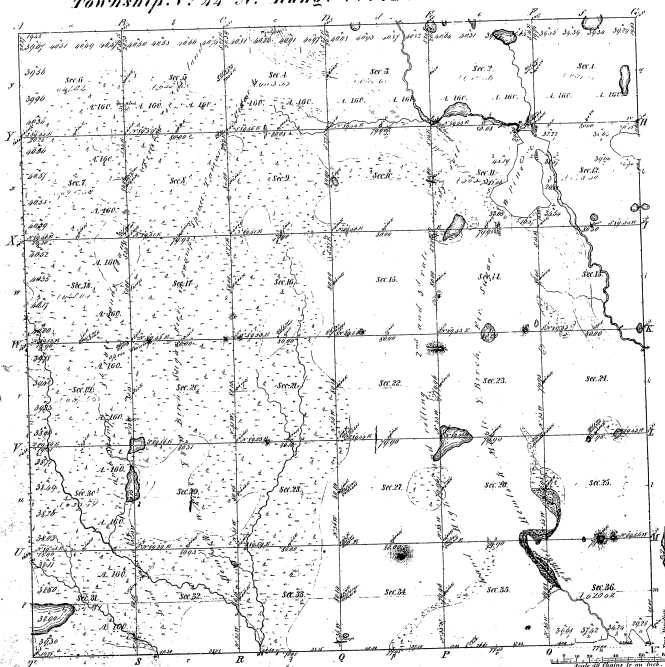

Boundaries of  
 Public Lands (W.M.) Private Lands (W.M.) Private Lands (W.M.)

37-23

37-23

Total number of Acres 2,122.36

Acres designated	By Whom Surveyed	Date of Survey	Amount of Acres	When Surveyed	By Whom Surveyed
2,122.36	Geo. W. Adams	April 2, 1855	2,122.36	2 <sup>nd</sup> Quarter 1855	Geo. W. Adams
	A. Montgomery	5, 19, 1855	2,122.36	2 <sup>nd</sup> Quarter 1855	A. Montgomery

The above map of Township 1° 44' North Range 1° 19' West of the Principal Meridian of Michigan is truly and correctly the full and true survey thereof as filed in the office of the Register and approved by the Register's Office  
 Charles J. Adams  
 Register

Exam. Copy made  
 Nov. 22, 1855

