

Township N. IV North, Range N. XI West Mer. (Mic. Tor.)

Oct. 25, 1851

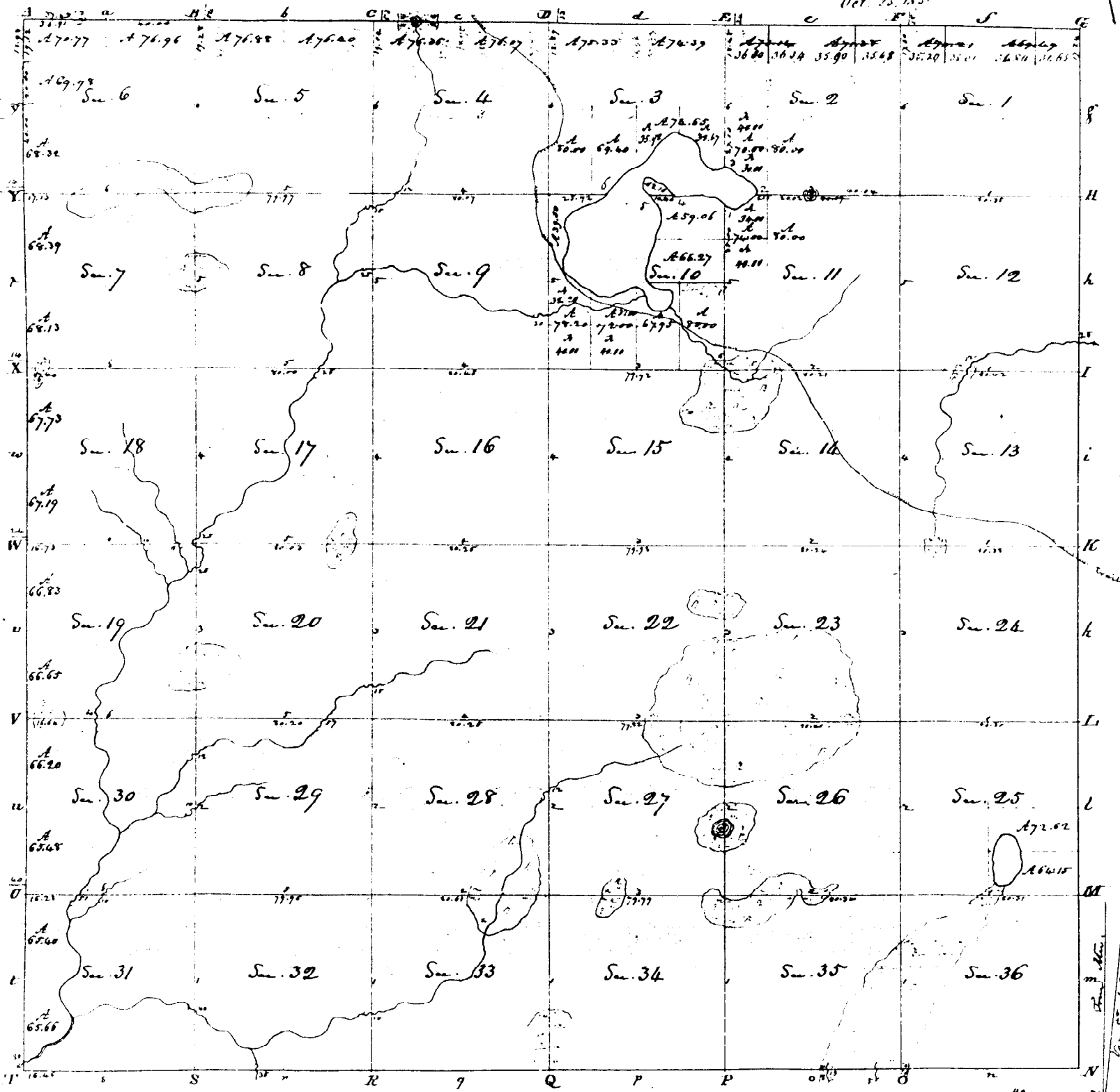

Surveyed in December 1830, & January 1831 by Sylvester Sibley, D.S.

Section		Area	Contents	Area
NE	1	69.49	SW 1/4	80
SW	"	80	SW 1/4	80
NW	"	70.21	SW 1/4	80
SE	"	80	SW 1/4	80
SW 1/4	"	320	SW 1/4	320
NE	2	71.38	SW 20	0.40
SW	"	80	SW 21	0.40
NW	"	73.14	SW 22	0.40
SE	"	80	SW 23	0.40
SW 1/4	"	160	SW 24	0.40
SW 1/4	"	80	NW 25	0.40
NE	3	70.00	NW SE	72.64
SW	"	74.39	SW	64.15
NW	"	80	SW 1/4	160
NW	"	75.33	SW 26	0.40
SW	"	80	SW 27	0.40
SW 1/4	"	74.65	SW 28	0.40
SW 1/4	"	69.40	SW 29	0.40
NW	"	80	SW 30	0.40
SW 1/4	"	8.15	SW 31	0.40
NW	"	78.07	SW 32	0.40
SW	"	80	SW 33	0.40
NW	"	78.36	SW 34	0.40
SW	"	80	SW 35	0.40
SW 1/4	"	320	SW 36	0.40
NE	4	78.40	SW 37	0.40
SW	"	80	SW 38	0.40
NW	"	78.88	SW 39	0.40
SW	"	80	SW 40	0.40
SW 1/4	"	320	SW 41	0.40
NE	5	78.96	SW 42	0.40
SW	"	80	SW 43	0.40
NW	"	70.77	SW 44	0.40
SW	"	69.98	SW 45	0.40
SW 1/4	"	160	SW 46	0.40
SW 1/4	"	80	SW 47	0.40
SW 1/4	"	68.32	SW 48	0.40
SW 1/4	"	320	SW 49	0.40
SW 1/4	"	80	SW 50	0.40
NW	"	68.39	SW 51	0.40
SW	"	80	SW 52	0.40
SW 1/4	"	68.13	SW 53	0.40
SW 1/4	"	64.0	SW 54	0.40
SW 1/4	"	64.0	SW 55	0.40
NW	"	59.86	SW 56	0.40
SW	"	68.27	SW 57	0.40
SW 1/4	"	39.50	SW 58	0.40
SW 1/4	"	80	SW 59	0.40
SW 1/4	"	67.95	SW 60	0.40
SW 1/4	"	72.00	SW 61	0.40
SW 1/4	"	78.20	SW 62	0.40
SW 1/4	"	160	SW 63	0.40
SW 1/4	"	80	SW 64	0.40
SW 1/4	"	74.00	SW 65	0.40
SW 1/4	"	320	SW 66	0.40
SW 1/4	"	64.0	SW 67	0.40
SW 1/4	"	64.0	SW 68	0.40
SW 1/4	"	64.0	SW 69	0.40
SW 1/4	"	64.0	SW 70	0.40
SW 1/4	"	64.0	SW 71	0.40
SW 1/4	"	64.0	SW 72	0.40
SW 1/4	"	64.0	SW 73	0.40
SW 1/4	"	64.0	SW 74	0.40
SW 1/4	"	64.0	SW 75	0.40
SW 1/4	"	64.0	SW 76	0.40
SW 1/4	"	64.0	SW 77	0.40
SW 1/4	"	64.0	SW 78	0.40
SW 1/4	"	64.0	SW 79	0.40
SW 1/4	"	64.0	SW 80	0.40
SW 1/4	"	64.0	SW 81	0.40
SW 1/4	"	64.0	SW 82	0.40
SW 1/4	"	64.0	SW 83	0.40
SW 1/4	"	64.0	SW 84	0.40
SW 1/4	"	64.0	SW 85	0.40
SW 1/4	"	64.0	SW 86	0.40
SW 1/4	"	64.0	SW 87	0.40
SW 1/4	"	64.0	SW 88	0.40
SW 1/4	"	64.0	SW 89	0.40
SW 1/4	"	64.0	SW 90	0.40
SW 1/4	"	64.0	SW 91	0.40
SW 1/4	"	64.0	SW 92	0.40
SW 1/4	"	64.0	SW 93	0.40
SW 1/4	"	64.0	SW 94	0.40
SW 1/4	"	64.0	SW 95	0.40
SW 1/4	"	64.0	SW 96	0.40
SW 1/4	"	64.0	SW 97	0.40
SW 1/4	"	64.0	SW 98	0.40
SW 1/4	"	64.0	SW 99	0.40
SW 1/4	"	64.0	SW 100	0.40