

Township N^o 49 N. Range N^o 31 W. Mer. Michigan

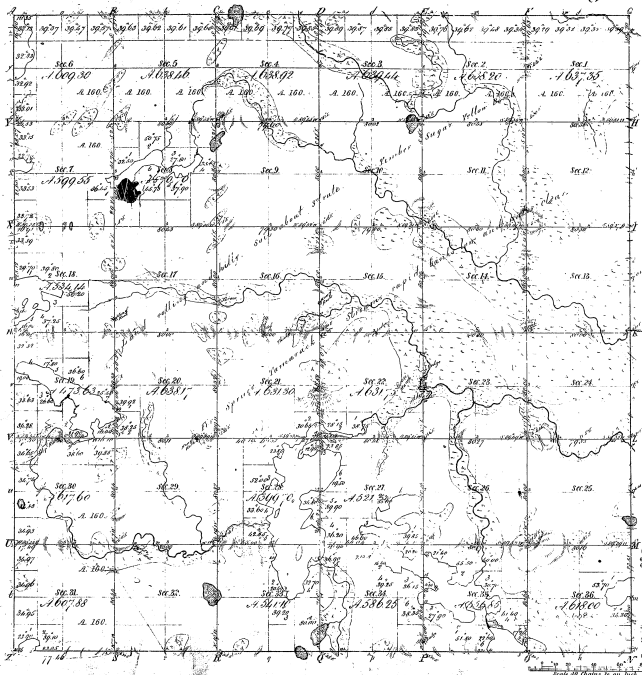

Measure of	
Feet	Inches
64	1
65	1
66	1
67	1
68	1
69	1
70	1
71	1
72	1
73	1
74	1
75	1
76	1
77	1
78	1
79	1
80	1
81	1
82	1
83	1
84	1
85	1
86	1
87	1
88	1
89	1
90	1
91	1
92	1
93	1
94	1
95	1
96	1
97	1
98	1
99	1
100	1

457

Total number of Acres 21,827.70

Parties designated	By whom surveyed	Date of Contract	Amount of Survey	When Surveyed	Section
Township lines	W. H. Wood & C. H. Wood	1816	4 3/4 1/2	1816	1116
Subdivisions	W. H. Wood & C. H. Wood	1816	21 1/2 1/2	1816	1116

The above map of Township N^o 49 N. Range N^o 31 West of 4th Principal Meridian Michigan is a true and correct copy of the field notes of the survey thereon on file in this office, which have been examined and approved.

Surveyor General
 Detroit Dec. 21, 1857
 Charles H. Wood
 Sp. Genl.

