

Township N. III North, Range N. VII West Mer. (Misc. Terr.)

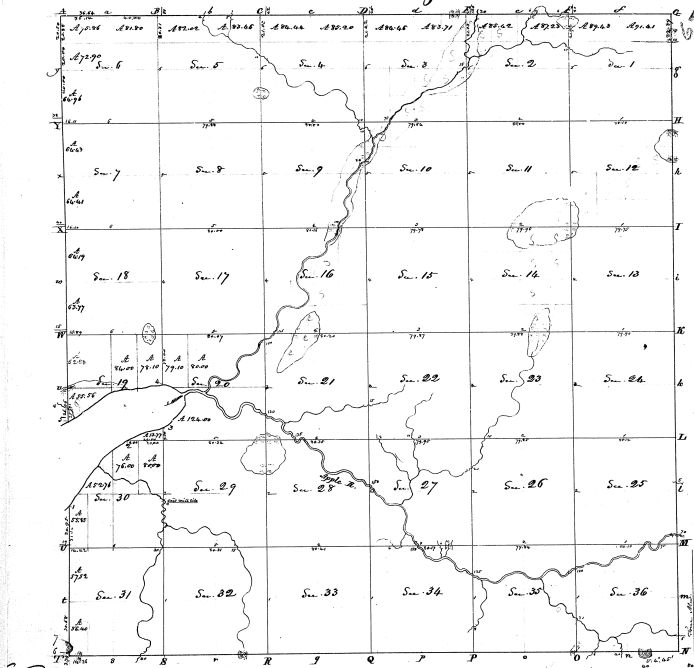

Surveyed in October & November, 1830. by Sylvester Hobbey & Co.

Contents		Acres	Misc.	Acres	Misc.
Sec. 1	SW	34	61	67	20
Sec. 1	SE	34	61	67	20
Sec. 2	SW	34	61	67	20
Sec. 2	SE	34	61	67	20
Sec. 3	SW	34	61	67	20
Sec. 3	SE	34	61	67	20
Sec. 4	SW	34	61	67	20
Sec. 4	SE	34	61	67	20
Sec. 5	SW	34	61	67	20
Sec. 5	SE	34	61	67	20
Sec. 6	SW	34	61	67	20
Sec. 6	SE	34	61	67	20
Sec. 7	SW	34	61	67	20
Sec. 7	SE	34	61	67	20
Sec. 8	SW	34	61	67	20
Sec. 8	SE	34	61	67	20
Sec. 9	SW	34	61	67	20
Sec. 9	SE	34	61	67	20
Sec. 10	SW	34	61	67	20
Sec. 10	SE	34	61	67	20
Sec. 11	SW	34	61	67	20
Sec. 11	SE	34	61	67	20
Sec. 12	SW	34	61	67	20
Sec. 12	SE	34	61	67	20
Sec. 13	SW	34	61	67	20
Sec. 13	SE	34	61	67	20
Sec. 14	SW	34	61	67	20
Sec. 14	SE	34	61	67	20
Sec. 15	SW	34	61	67	20
Sec. 15	SE	34	61	67	20
Sec. 16	SW	34	61	67	20
Sec. 16	SE	34	61	67	20
Sec. 17	SW	34	61	67	20
Sec. 17	SE	34	61	67	20
Sec. 18	SW	34	61	67	20
Sec. 18	SE	34	61	67	20
Sec. 19	SW	34	61	67	20
Sec. 19	SE	34	61	67	20
Sec. 20	SW	34	61	67	20
Sec. 20	SE	34	61	67	20
Sec. 21	SW	34	61	67	20
Sec. 21	SE	34	61	67	20
Sec. 22	SW	34	61	67	20
Sec. 22	SE	34	61	67	20
Sec. 23	SW	34	61	67	20
Sec. 23	SE	34	61	67	20
Sec. 24	SW	34	61	67	20
Sec. 24	SE	34	61	67	20
Sec. 25	SW	34	61	67	20
Sec. 25	SE	34	61	67	20
Sec. 26	SW	34	61	67	20
Sec. 26	SE	34	61	67	20
Sec. 27	SW	34	61	67	20
Sec. 27	SE	34	61	67	20
Sec. 28	SW	34	61	67	20
Sec. 28	SE	34	61	67	20
Sec. 29	SW	34	61	67	20
Sec. 29	SE	34	61	67	20
Sec. 30	SW	34	61	67	20
Sec. 30	SE	34	61	67	20
Sec. 31	SW	34	61	67	20
Sec. 31	SE	34	61	67	20
Sec. 32	SW	34	61	67	20
Sec. 32	SE	34	61	67	20
Sec. 33	SW	34	61	67	20
Sec. 33	SE	34	61	67	20
Sec. 34	SW	34	61	67	20
Sec. 34	SE	34	61	67	20
Sec. 35	SW	34	61	67	20
Sec. 35	SE	34	61	67	20
Sec. 36	SW	34	61	67	20
Sec. 36	SE	34	61	67	20

11842 43
11843 57
Total 32224 57

15-9