

Township N. 14 North, Range N. 13 East Mer. (the Top)

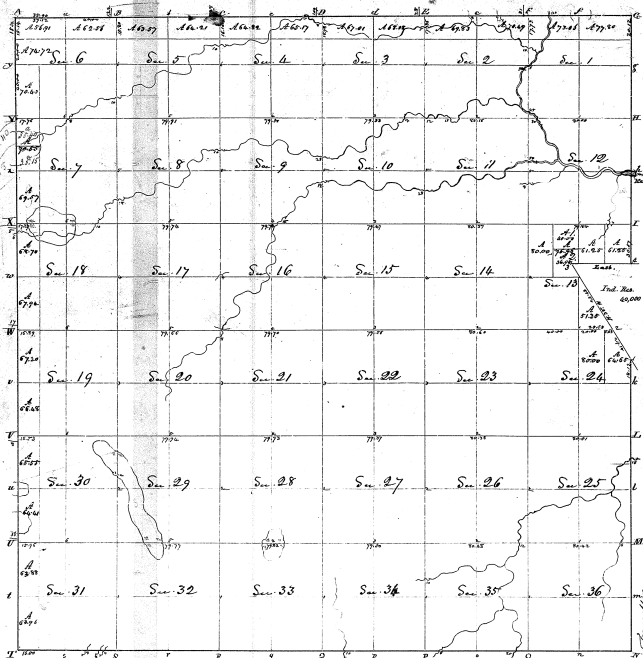

Surveyed in March 1881, by Harvey Parker D.S.

The above map of Township N. 14 N. of Range N. 13 East of the principal Meridian (Mer. 100) is hereby confirmed to the field notes of the Survey thereof on file in this Office, which have been examined & approved.
 Surveyor General's Office?
 Cincinnati, Dec 30, 1882

H. J. Williams

Sections		Contents		Acres	Value
Sec.	Cont.	Acres	Value		
N. 176	1	77	60	60	17.00
Sc	"	80	60	60	17.00
Sc	"	70	60	60	17.00
Sc	"	30	60	60	17.00
N. 176	2	79	60	60	17.00
Sc	"	80	60	60	17.00
Sc	"	60	60	60	17.00
Sc	"	30	60	60	17.00
N. 176	3	79	60	60	17.00
Sc	"	80	60	60	17.00
Sc	"	60	60	60	17.00
Sc	"	30	60	60	17.00
N. 176	4	80	60	60	17.00
Sc	"	80	60	60	17.00
Sc	"	60	60	60	17.00
Sc	"	30	60	60	17.00
N. 176	5	80	60	60	17.00
Sc	"	80	60	60	17.00
Sc	"	60	60	60	17.00
Sc	"	30	60	60	17.00
N. 176	6	80	60	60	17.00
Sc	"	80	60	60	17.00
Sc	"	60	60	60	17.00
Sc	"	30	60	60	17.00
N. 176	7	80	60	60	17.00
Sc	"	80	60	60	17.00
Sc	"	60	60	60	17.00
Sc	"	30	60	60	17.00
N. 176	8	80	60	60	17.00
Sc	"	80	60	60	17.00
Sc	"	60	60	60	17.00
Sc	"	30	60	60	17.00
N. 176	9	80	60	60	17.00
Sc	"	80	60	60	17.00
Sc	"	60	60	60	17.00
Sc	"	30	60	60	17.00
N. 176	10	80	60	60	17.00
Sc	"	80	60	60	17.00
Sc	"	60	60	60	17.00
Sc	"	30	60	60	17.00
N. 176	11	80	60	60	17.00
Sc	"	80	60	60	17.00
Sc	"	60	60	60	17.00
Sc	"	30	60	60	17.00
N. 176	12	80	60	60	17.00
Sc	"	80	60	60	17.00
Sc	"	60	60	60	17.00
Sc	"	30	60	60	17.00
N. 176	13	80	60	60	17.00
Sc	"	80	60	60	17.00
Sc	"	60	60	60	17.00
Sc	"	30	60	60	17.00
N. 176	14	80	60	60	17.00
Sc	"	80	60	60	17.00
Sc	"	60	60	60	17.00
Sc	"	30	60	60	17.00
N. 176	15	80	60	60	17.00
Sc	"	80	60	60	17.00
Sc	"	60	60	60	17.00
Sc	"	30	60	60	17.00
N. 176	16	80	60	60	17.00
Sc	"	80	60	60	17.00
Sc	"	60	60	60	17.00
Sc	"	30	60	60	17.00
N. 176	17	80	60	60	17.00
Sc	"	80	60	60	17.00
Sc	"	60	60	60	17.00
Sc	"	30	60	60	17.00
N. 176	18	80	60	60	17.00
Sc	"	80	60	60	17.00
Sc	"	60	60	60	17.00
Sc	"	30	60	60	17.00
N. 176	19	80	60	60	17.00
Sc	"	80	60	60	17.00
Sc	"	60	60	60	17.00
Sc	"	30	60	60	17.00
N. 176	20	80	60	60	17.00
Sc	"	80	60	60	17.00
Sc	"	60	60	60	17.00
Sc	"	30	60	60	17.00
N. 176	21	80	60	60	17.00
Sc	"	80	60	60	17.00
Sc	"	60	60	60	17.00
Sc	"	30	60	60	17.00
N. 176	22	80	60	60	17.00
Sc	"	80	60	60	17.00
Sc	"	60	60	60	17.00
Sc	"	30	60	60	17.00
N. 176	23	80	60	60	17.00
Sc	"	80	60	60	17.00
Sc	"	60	60	60	17.00
Sc	"	30	60	60	17.00
N. 176	24	80	60	60	17.00
Sc	"	80	60	60	17.00
Sc	"	60	60	60	17.00
Sc	"	30	60	60	17.00
N. 176	25	80	60	60	17.00
Sc	"	80	60	60	17.00
Sc	"	60	60	60	17.00
Sc	"	30	60	60	17.00
N. 176	26	80	60	60	17.00
Sc	"	80	60	60	17.00
Sc	"	60	60	60	17.00
Sc	"	30	60	60	17.00
N. 176	27	80	60	60	17.00
Sc	"	80	60	60	17.00
Sc	"	60	60	60	17.00
Sc	"	30	60	60	17.00
N. 176	28	80	60	60	17.00
Sc	"	80	60	60	17.00
Sc	"	60	60	60	17.00
Sc	"	30	60	60	17.00
N. 176	29	80	60	60	17.00
Sc	"	80	60	60	17.00
Sc	"	60	60	60	17.00
Sc	"	30	60	60	17.00
N. 176	30	80	60	60	17.00
Sc	"	80	60	60	17.00
Sc	"	60	60	60	17.00
Sc	"	30	60	60	17.00
N. 176	31	80	60	60	17.00
Sc	"	80	60	60	17.00
Sc	"	60	60	60	17.00
Sc	"	30	60	60	17.00
N. 176	32	80	60	60	17.00
Sc	"	80	60	60	17.00
Sc	"	60	60	60	17.00
Sc	"	30	60	60	17.00
N. 176	33	80	60	60	17.00
Sc	"	80	60	60	17.00
Sc	"	60	60	60	17.00
Sc	"	30	60	60	17.00
N. 176	34	80	60	60	17.00
Sc	"	80	60	60	17.00
Sc	"	60	60	60	17.00
Sc	"	30	60	60	17.00
N. 176	35	80	60	60	17.00
Sc	"	80	60	60	17.00
Sc	"	60	60	60	17.00
Sc	"	30	60	60	17.00
N. 176	36	80	60	60	17.00
Sc	"	80	60	60	17.00
Sc	"	60	60	60	17.00
Sc	"	30	60	60	17.00
Total				1141.00	1141.00
Total				1141.00	1141.00

13
13

