



ORIGINAL

SHEET 2 OF 2

TOWNSHIP 41 NORTH, RANGE 7 EAST, OF THE MICHIGAN MERIDIAN, MICHIGAN.  
SURVEY OF ISLANDS

33-29

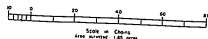
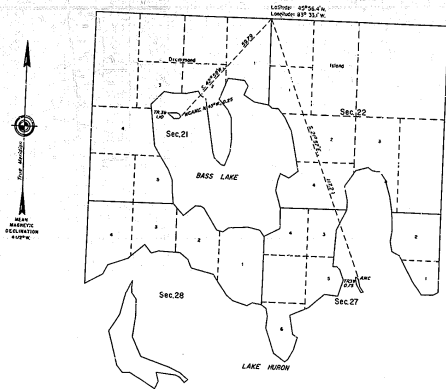

Reference should be made to Sheet No. 1 for survey information.

UNITED STATES DEPARTMENT OF THE INTERIOR  
BUREAU OF LAND MANAGEMENT  
Denver, Colorado November 19, 1961

This plan is strictly conformable to the approved field notes, and the survey, having been correctly executed in accordance with the requirements of law and the regulations of this Bureau, is hereby accepted.

For the Director

Acting Chief, Cadastral Survey  
Examination and Approval Staff

TOWNSHIP 41 NORTH, RANGE 7 EAST, OF THE MICHIGAN MERIDIAN, MICHIGAN.  
SURVEY OF ISLANDS

33-29

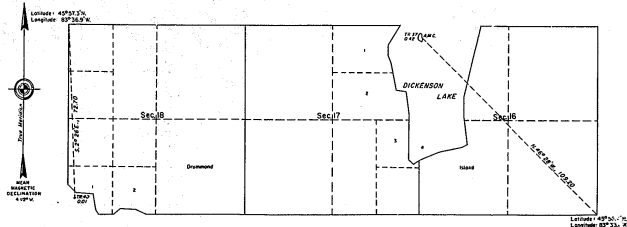

A history of surveys is contained in the field notes.

This plat, in two sheets, represents the survey of one island in Dickenson Lake, one island in Bass Lake and two islands in Lake Huron, T. 41 N., R. 7 E., Michigan Meridian, Michigan.

Except as indicated herein, the lottings and areas are as shown on the plat approved January 31, 1846.

Survey executed by Gary L. Klatz, Cadastral Surveyor, beginning August 10, 1977, and completed September 1, 1977, pursuant to Special Instructions dated June 3, 1977, for Group No. 78, Michigan.

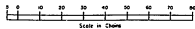

Area Surveyed: 0.42 Acres

UNITED STATES DEPARTMENT OF THE INTERIOR  
BUREAU OF LAND MANAGEMENT  
Denver, Colorado November 19, 1981

This plat is strictly conformable to the approved field notes, and the survey, having been correctly executed in accordance with the requirements of law and the regulations of this Bureau, is hereby accepted.

For the Director

*James D. Hildner*

Acting Chief, Cadastral Survey  
Examination and Approval Staff