

T 20. N. Range No 1 W. Ber. Mich.
Resurvey

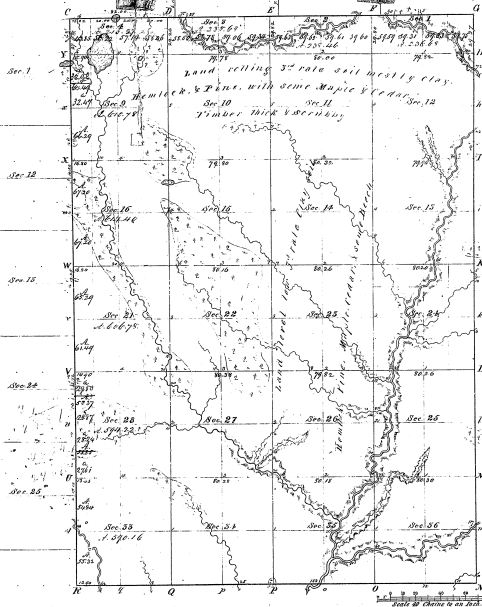

Measure of
Perch Acres 111.1

73-4
23-7

Total number of acres 155.12.45

Survey Disposed	By Whom Surveyed	Date of Convey.	Area of Survey in 1/4, 1/2, 3/4	Area Claimed by the Govt. and not surveyed	Area Surveyed
Survey Disposed	John Brown	Aug 10, 1868	6.26.48	1.27.11.37	
Survey Disposed	Charles Brown	July 10, 1877	10.17.26	2.27.11.27	
Survey Disposed	John Brown	Aug 10, 1868	35.28.58	2.27.11.26	

On along line of Township 20 North of Range 1 West of the
Principal Meridian. Application of John Brown
of the survey being on file in the office, which has been examined and approved.
Surveyor General's Office
John Brown, Jr. Sec.

Lucius Lyon, Sec'y