

Township N. 10 North, Range N. III West 4th Mer. (Ill. Ter.)

502

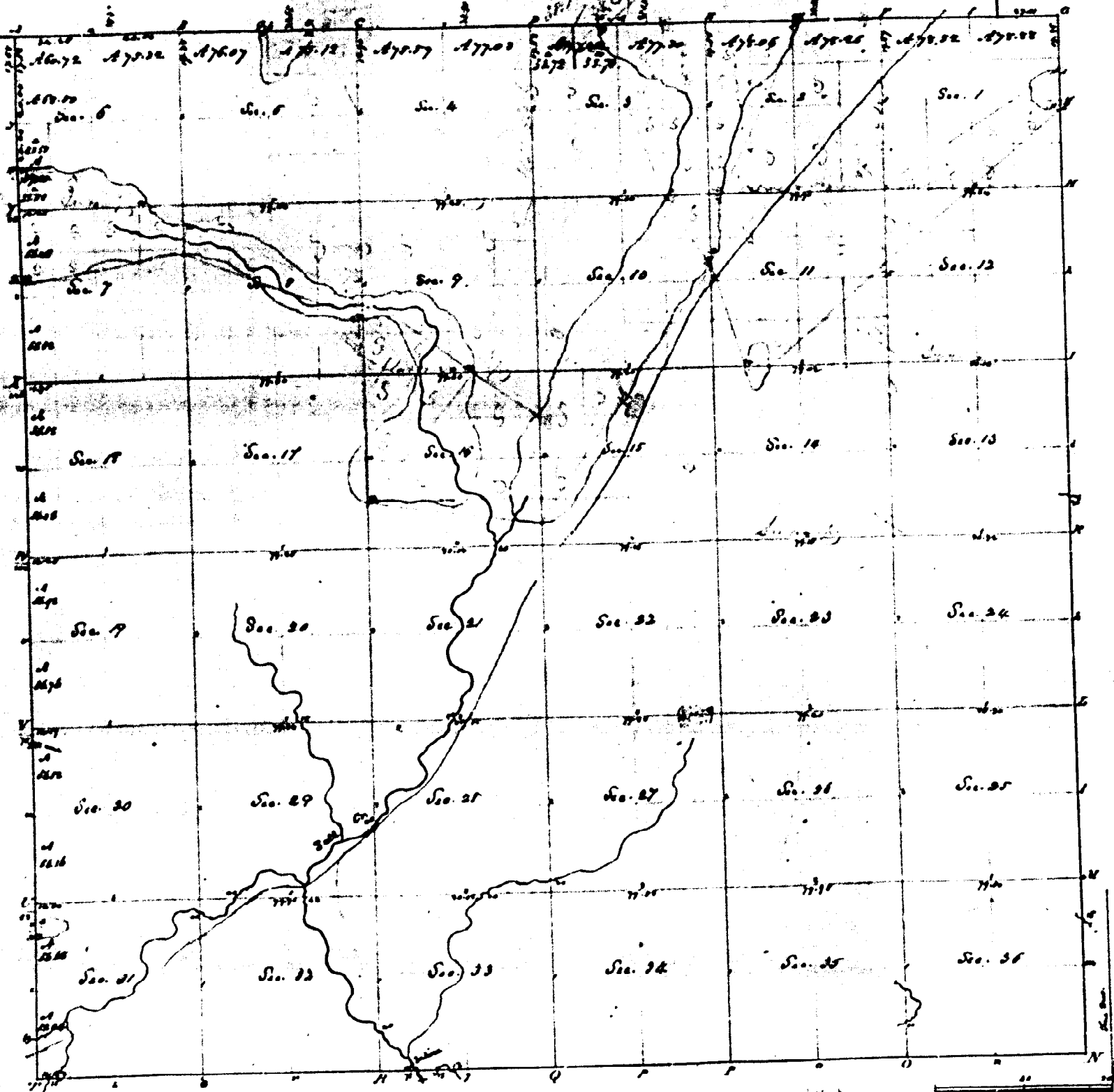

Sections	Class	Vol.	Sections	Area	Acres
1	67	75 11	67	11	320
2	80	75 11	67	11	50
3	77	75 12	77	12	58 92
4	80	75 12	67	67	80
5	320	77	77	12	58 76
6	77	75 21	67	20	640
7	80	75 21	67	21	640
8	77	75 21	67	21	640
9	80	75 21	67	21	640
10	320	75 21	67	21	640
11	77	77 30	67	25	640
12	80	77 30	67	25	640
13	77	77 42	67	27	640
14	80	77 42	67	27	640
15	320	77 42	67	27	640
16	77	77 53	67	30	640
17	80	77 53	67	30	640
18	77	77 59	67	31	56 52
19	80	77 59	67	31	80
20	320	77 59	67	31	58 15
21	77	75 12	67	31	320
22	80	75 12	67	31	80
23	77	76 07	67	31	58 68
24	80	76 07	67	31	80
25	320	76 07	67	31	58 04
26	77	75 32	67	32	640
27	80	75 32	67	32	640
28	77	60 72	67	32	640
29	80	60 72	67	32	640
30	56	160	67	32	640
31	57	80	67	32	11 381 08
32	77	57 00	67	32	11 397 79
33	80	320	67	32	12 718 87
34	77	80	67	32	
35	57	58 48	67	32	
36	77	57 52	67	32	
	67	640	67	32	
	7	640	67	32	
	10	640	67	32	
	11	640	67	32	
	12	640	67	32	
	13	640	67	32	
	14	640	67	32	
	15	640	67	32	
	16	640	67	32	
	17	640	67	32	
	18	320	67	32	
	67	80	67	32	
	77	55 52	67	32	
	80	80	67	32	
	77	58 68	67	32	
	77	11 357 79	67	32	

Surveyed in . . . . . 1831 - by Lord Wright & S.

The above map of Township N. 10 N., Range N. 3 W. of the Mer. (Ill. Ter.) is strictly conformable to the field notes of the Survey kept on file in this office, which have been examined & approved  
 Surveyor General's Office  
 Cincinnati, Oct. 6, 1851  
 M. T. Williams  
 Secy.