

Township N^o XIII N. Range N^o III W. Mer. Mic. Ser.

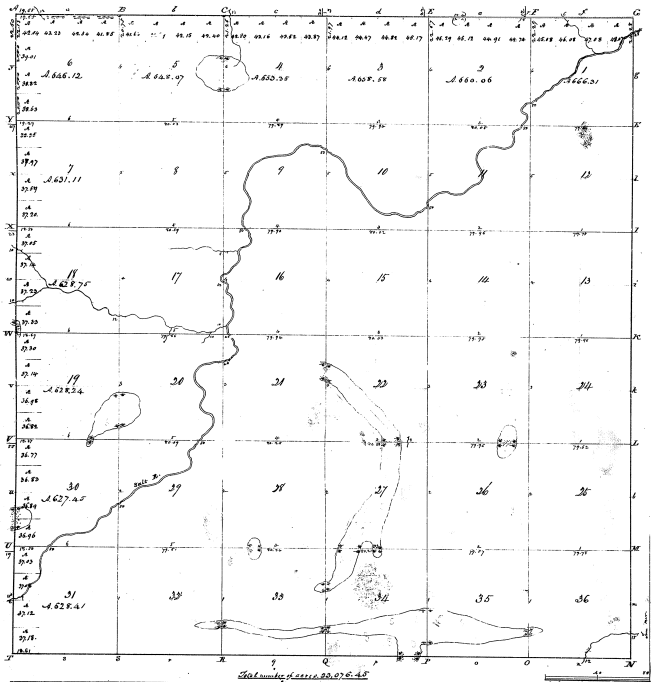

13-30

13-30

original
 Survey made by John Barry, & set of same on 7 maps, the survey of L. L. & Co.
 from Thomas R. Clark 17 Nov 1830
 the divisions of land bought 1 Dec 1836 to 27 3^d 1838 p. 182

The plan map of Township N^o 13 North of Range N^o 3 West
 Merion. Mich. Survey Territory is strictly conformable to the Sec. 36
 Act of the 27th May 1820 - a file in this office, which has been
 forwarded each year.

Survey made by
 Thomas R. Clark
 M. J. Williams
 Jan 1830