

# Township N<sup>o</sup> 13 N. Range N<sup>o</sup> 6 West Mer. (Mich)

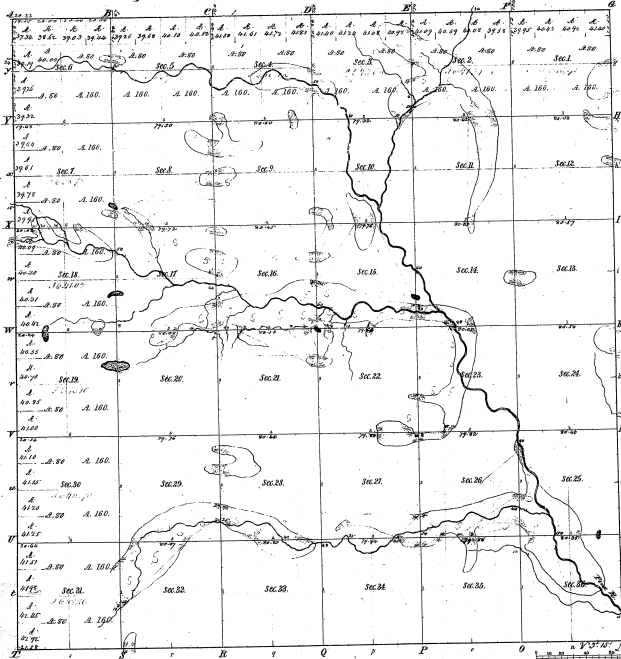

Measure of					
Point	Course	Dist.	Point	Course	Dist.

12-30

Survey Designated	By Whom Surveyed	Date of Contract	Amount of Survey	When Surveyed	Area of the land in Acs	Area of the land in Secs
Township lines	John & Henry	July 2	68.82	57	1739	1739
Subdivisions	John & Henry	July 7	68.82	67	1739	1739
Total number of acres		34,763.54				

After above Map of Township N. 13 North of Range N. 6 West of this 1st Meridian, Michigan, West of 100th Meridian, is hereby approved to the full notes of the survey thereon on file in this Office which have been measured and approved.

Surveyor General's Office  
 Excelsior, Minn. July 17, 1899  
 J. P. Keary, Supt. Gen.