

PLAT OF AN ISLAND
 in
 CROOKED LAKE,
 in
 Secs. 5 and 6, T. 17 N., R. 12 W., Michigan Meridian,
 MICHIGAN.

16-11
 11-16

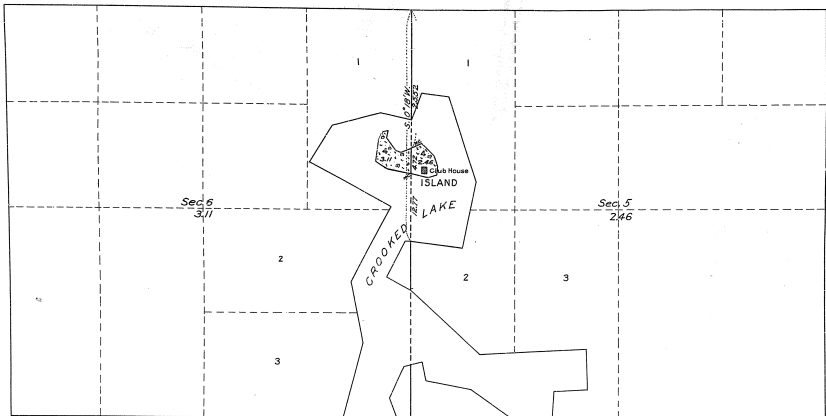

LEGEND

Scale: 10 Chains to an inch.

Surveyed by Albinus H. Kimmel, U.S. Surveyor, from June 28 to July 5, 1916, incl., under special instructions dated June 8, 1916, issued by Arthur D. Kidder, Supervisor of Surveys, bearing the approval of the Commissioner of the General Land Office under date of June 20, 1916.

Area of lands surveyed = 5.57 acres, not shown upon the plat approved June 10, 1939.
 Area of previously surveyed lands not shown.

G. A. J.

 Department of the Interior,
 General Land Office,
 Washington, D.C. February 1, 1918.

The above plat of an Island in Crooked Lake, in Sections 5 and 6, T. 17 N., R. 12 W., Michigan Meridian, Michigan, is strictly conformable to the field notes of the survey thereof, on file in this office, which have been examined and approved.

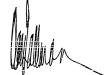
 Commissioner of the
 U.S. Survey General for Michigan