

27-32

27-32

MEANDER SURVEY OF ELIZABETH LAKE
 in Fractional Sections 27, 28, 33 and 34,
 Township 3 North, Range 9 East, Michigan Meridian,
 MICHIGAN.

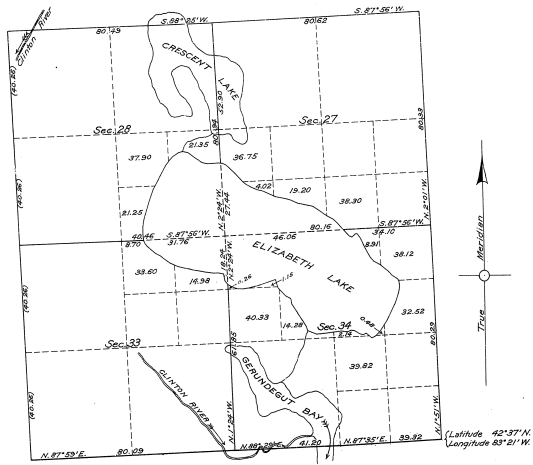

This plat is based upon a meander survey of Elizabeth Lake, the same being shown as a lake upon the official plat approved February 20, 1818, but which was not meandered in the survey executed by Samuel Carpenter, D.S., in 1817. The necessary section lines have been retraced, and the points of intersection of said original lines with the shore line of the lake, as occupied at the date of the original survey, have been monumented as meander corners.

Scale: 20 chains to an inch.
 Survey commenced January 26, 1915.
 Survey completed February 12, 1915.

A. W. S.
 C. D. R.

Department of the Interior,
 General Land Office,
 Washington, D.C., Dec. 27, 1915.

The above plat of Elizabeth Lake, in fractional sections 27, 28, 33 and 34, Township 3 North, Range 9 East, of the Michigan Meridian, Michigan, meandered by Lester L. Clement, U.S. Surveyor, and Donald B. Clement, U.S. Transient, pursuant to instructions issued by this office, under date of January 11, 1915, is strictly conformable to the field notes of said survey on file in this office, which have been examined and approved.

[Signature]
 Commissioner and ex officio
 U.S. Surveyor-General for Michigan.