

Township N. 13 North, Range N. 18 West Mer. (Mich.)

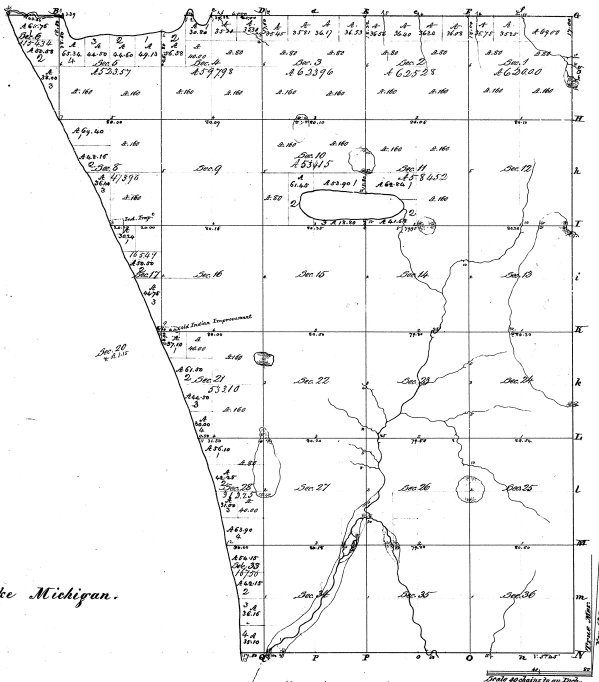

Lake Michigan.

9-17

L-1

Abstracts of Sales	
Book	Page
1	2771
2	2772
3	2773
4	2774
5	2775
6	2776
7	2777
8	2778
9	2779
10	2780
11	2781
12	2782
13	2783
14	2784
15	2785
16	2786
17	2787
18	2788
19	2789
20	2790
21	2791
22	2792
23	2793
24	2794
25	2795
26	2796
27	2797
28	2798
29	2799
30	2800
31	2801
32	2802
33	2803
34	2804
35	2805
36	2806

1831331

For	Line	Submittal	17	1831	14	50	6 th gr	1831	5	gr	1831
Abstract	Line	Submittal	28	1831	19	50	1 st gr	1831	1	gr	1831

The above Map, of Township N. 13 North, of Range N. 18 West of the Principal Meridian, Michigan, is strictly conformable to the field notes of its survey, filed on file in this office, which have been examined and approved.

Surveyor General's Office,
 Ann Arbor, Mich., Aug. 10th 1831

P. P. Leary, Surveyor General.