

Township N<sup>o</sup> 15 N. Range N<sup>o</sup> 18 West Mer. Mich.

Lake Michigan.

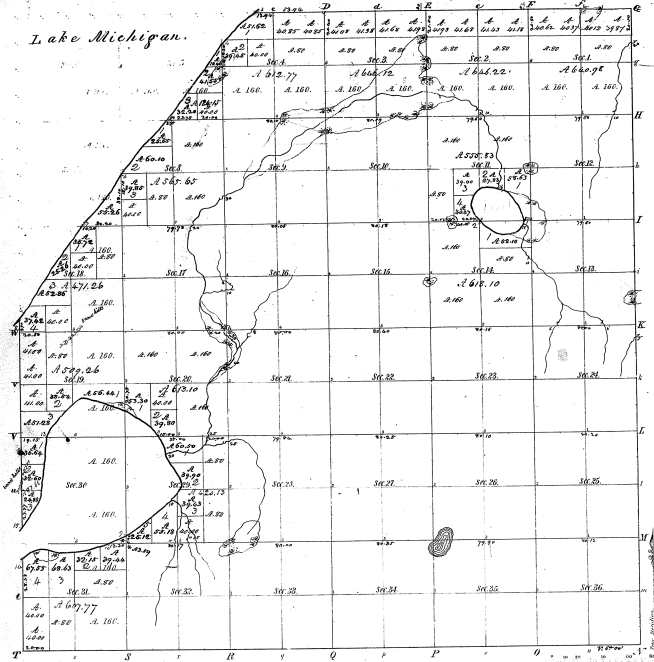

Numbers of Sections.

Section	Acres	Section	Acres
1	360.00	17	360.00
2	360.00	18	360.00
3	360.00	19	360.00
4	360.00	20	360.00
5	360.00	21	360.00
6	360.00	22	360.00
7	360.00	23	360.00
8	360.00	24	360.00
9	360.00	25	360.00
10	360.00	26	360.00
11	360.00	27	360.00
12	360.00	28	360.00
13	360.00	29	360.00
14	360.00	30	360.00
15	360.00	31	360.00
16	360.00	32	360.00
17	360.00	33	360.00
18	360.00	34	360.00
19	360.00	35	360.00
20	360.00	36	360.00

9-12

Total number of Acres 12980.00

Survey Designated	By Whom Surveyed	Date of Contract	Amount of Acres	When Surveyed	How far and in what direction from the Sec. 10
Township lines	W. M. Wallace	17. day 1837	17. 52. 66	1838	1/2 m. N. of Sec. 10
Subdivisions	W. M. Wallace	16. day 1837	63. 71. 66	1838. 1. yr. 1839	1/2 m. N. of Sec. 10

The above map of Township N<sup>o</sup> 15 N., Range N<sup>o</sup> 18 West of the Principal Meridian, Michigan, is hereby recognized to the full extent of the survey thereon, in full in that portion thereof, has been examined and approved.

Survey Sample Copy  
 Cincinnati, August 16<sup>th</sup> 1839  
*P. S. Peckham* Surveyor