

Township 1° 20' N. Range N° 1 E. Mer. Mich.

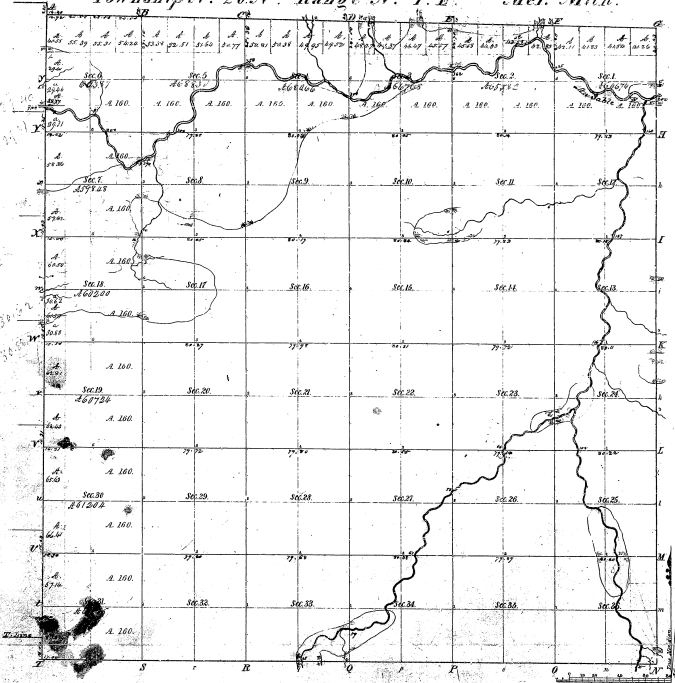

Boundaries or
 Part Courses or Part Courses or Part Courses or Part Courses or Part Courses or

21-17

21-17

Total number of Acres 3307.72

Survey Description	By Whom Surveyed	Date of Survey	Amount of Survey	When Surveyed	Range and Meridian
Section 10	John A. ...	1857	160
Section 11	John A. ...	1857	160
Section 12	John A. ...	1857	160
Section 13	John A. ...	1857	160
Section 14	John A. ...	1857	160
Section 15	John A. ...	1857	160
Section 16	John A. ...	1857	160
Section 17	John A. ...	1857	160
Section 18	John A. ...	1857	160
Section 19	John A. ...	1857	160
Section 20	John A. ...	1857	160
Section 21	John A. ...	1857	160
Section 22	John A. ...	1857	160
Section 23	John A. ...	1857	160
Section 24	John A. ...	1857	160
Section 25	John A. ...	1857	160
Section 26	John A. ...	1857	160
Section 27	John A. ...	1857	160
Section 28	John A. ...	1857	160
Section 29	John A. ...	1857	160
Section 30	John A. ...	1857	160
Section 31	John A. ...	1857	160
Section 32	John A. ...	1857	160
Section 33	John A. ...	1857	160
Section 34	John A. ...	1857	160
Section 35	John A. ...	1857	160
Section 36	John A. ...	1857	160

The above copy of Township 1° 20' N. Range N° 1 E. East of the
 Michigan Meridian, stands upon a copy of the original plat
 of the survey, and is a true and correct copy of the original plat
 as the same appears on file in the office of the Surveyor General
 of the State of Michigan.

Surveyor General of Michigan
 G. W. ...

