

Resurvey Township 21^N Range 4^W Mer. Mich.

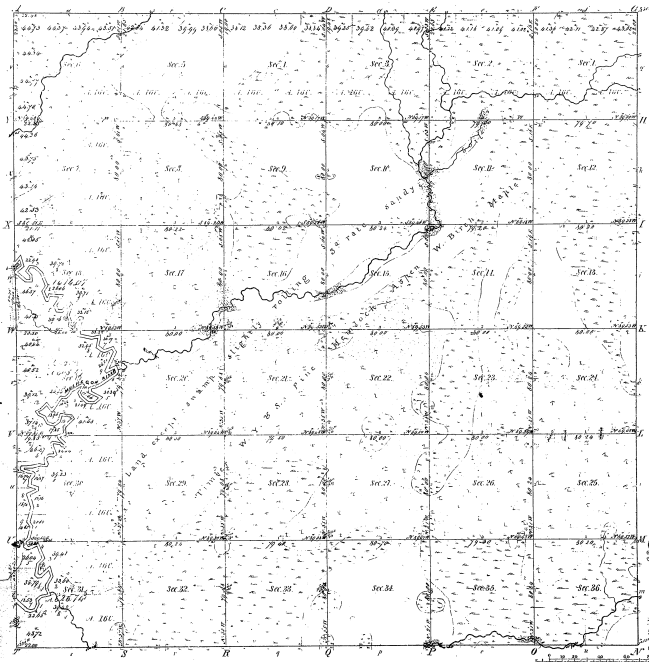

Total number of acres **22,926.33**

Survey designated	By whom surveyed	Date of contract	Amount of survey	When surveyed	How far and in what direction from
Township 21 ^N Range 4 ^W Mer.	A. C. Berman	May 25 th 1852	36	22	2 1/2 miles ESE
Subdivisions	Artemus Clarke	April 24 th 1852	61 x 35 = 2135	1852	1/4 mile S

This plat represents Township 21 N. of Range 4 W. of Meridian Michigan, as actually surveyed to the field notes of the survey being published hereafter, and as approved by the Survey General Office.

Artemus Clarke
1852

Boundaries of
Twp. 21^N Range 4^W Mer. Mich.

14-40
