

**SURVEY & REMONUMENTATION**

FEB 03 1999

SECTION

**BRANCH COUNTY REMONUMATION PROGRAM  
LAND CORNER RECORDATION CERTIFICATE  
Filing Requirement of Act 74, Mich. P.A. 1970**

For corners in

<u>BRANCH COUNTY</u> Ovid TWP	Located In:	Corner Code #
1. Public Land Survey	T <u>7 S</u> R <u>6 W</u>	<u>C-3</u>
	T _____ R _____	_____
	T _____ R _____	_____
	T _____ R _____	_____
2. Property Controlling in Section	S _____ T _____ R _____	_____
	S _____	_____
	T _____ R _____	_____
3. Miscellaneous	S _____	_____
	T _____ R _____	_____
Property in Sec.	S _____	_____
	T _____ R _____	_____

STATE OF MICHIGAN  
Branch County  
Recorded

11-04-1998 15:47:21

Linda Lee Morrison-Mathews  
REGISTER OF DEEDS

Register of Deeds Stamp & File Number

ACCEPTED BY THE BRANCH COUNTY  
SURVEY PEER GROUP AS THE OFFICIAL  
CORNER UNDER MICHIGAN PUBLIC ACT 345  
OF 1990 AT A MEETING HELD ON  
9-09-98

*E.R. Reed Co. Rep.*  
**E.R. REED**

4. Lot No. \_\_\_\_\_, Recorded Plat \_\_\_\_\_  
5. Private Claims \_\_\_\_\_

	A	B	C	D	E	F	G	H	I	J	K	L	M
1													
2	6		5		4		3		2		1		
3			●										
4	7		8		9		10		11		12		
5													
6	18		17		16		15		14		13		
7													
8	19		20		21		22		23		24		
9													
10	30		29		28		27		26		25		
11													
12	31		32		33		34		35		36		
13													

I, EDWARD W. REED, in a field survey on JULY 14, 1998 do hereby state that under requirements of P.A. 74, Michigan P.A. of 1970, the corner points mentioned in lines 1 and 2 above were in conformance with regulations and rules therefore as required in the current manual of survey instructions of the United States Department of the Interior, Bureau of Land Management or by a decree of a Court of Law and /or that the corner points mentioned in lines 3, 4 and 5 above were in conformance with the rules of the Michigan Board of Land Surveyors or by a Decree of a Court of Law; established, re-established, monumented, recovered, found as expressed below:

NOTE: Not more than 2 corners, all in the same town and range, may be recorded on this certificate.

CORNER COMMON TO SECTIONS 5-6-7-8

A. Description of original monument and accessories and/or subsequent restoration:

1826: WM BROOKFIELD D. S. - CORNER SET  
1871: M. KNOWLES - D. S. FOUND STONE  
1987: E. R. REED, CO. SURVEYOR - DUG FOR CORNER. PROBABLY REMOVED DURING ROAD BUILDING OPERATIONS. RESET CORNER (IRON PIPE IN CI-MONUMENT BOX) FROM OLD SCHOOL HOUSE FENCES. RECORDED IN LCRC # II-0096

B. Description of corner evidence found and/or method applied in restoring or reestablishing corner:

FOUND MONUMENT BOX AND IRON PIPE

C. Description of monument for corner and accessories established to perpetuate locating the position of the corner:

SET 1/2" X 18" REBAR IRON IN IRON PIPE WITH REMON CAP IN CAST IRON BOX

C/L OF E- W ROAD	SOUTH	6.0'
CENTER OF 14' ASH	N 52 W	49.6'
SOUTH WEST CORNER OF ORIGINAL BRICK CHURCH	N 50 E	93.5'
FACE OF TEL PED	N 51 W	43.3'
FENCELINE RUNNING	SOUTHWEST	82.5'

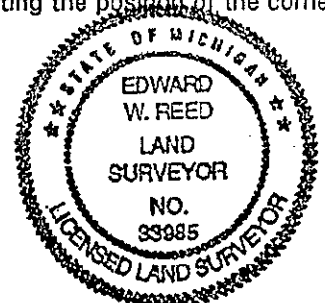

AND IS ACCEPTED AS THE BEST AVAILABLE EVIDENCE OF THE POSITION OF THE ORIGINAL CORNER.

Signed by *Edward W. Reed*  
EDWARD W, REED

Date SEPTEMBER 9, 1998

Surveyor's Michigan License No. 33985

Liber 00003 Page 0221