

LAND CORNER RECORDATION CERTIFICATE  
Filing Requirement of Act 74, Mich. P.A. 1970

For corners in  
Chippewa

(County)

Located in:

Corner Code #

1. Public Land Survey

T 44N R 1W J6

T R

T R

T R

2. Property Controlling  
in Section

S 14 T 44N R 1W 11

S T R

3. Miscellaneous  
Property in Sec.

S T R

S T R

Register of Deeds Stamp & File Number

4. Lot No. , Recorded Plat

5. Private Claims

11 Jun 25 2003  
J6 Jul 08 2003

I, Stephan J. Szyszkoski, in a field survey on \_\_\_\_\_, 20\_\_\_\_ do hereby state that under requirements of P.A. 74, Michigan P.A. of 1970, the corner points mentioned in lines 1 and 2 above were in conformance with regulations and rules therefore as required in the current manual of survey instructions of the United States Department of the Interior, Bureau of Land Management or by a decree of a Court of Law and /or that the corner points mentioned in lines 3, 4 and 5 above were in conformance with the rules of the Michigan Board of Land Surveyors or by a Decree of a Court of Law; established, re-established, monumented, recovered, found as expressed below:

NOTE: Not more than 2 corners, all in the same town and range, may be recorded on this certificate.

	A	B	C	D	E	F	G	H	I	J	K	L	M
1													
2		6		5		4		3		2		1	
3													
4		7		8		9		10		11		12	
5													
6		18		17		16		15		14		13	
7													
8		19		20		21		22		23		24	
9													
10		30		29		28		27		26		25	
11													
12		31		32		33		34		35		36	
13													

A. Description of original monument and accessories and/or subsequent restoration:

(J6) Center of Section 14. Not established in the original survey.

(11-Sec. 14) Southwest 1/16 corner, Section 14. Not established in the original survey.

B. Description of corner evidence found and/or method applied in restoring or reestablishing corner:

(J6) Established the corner at the intersection of straight lines connecting opposite 1/4 corners.

(11-Sec. 14) Established the corner at the intersection of straight lines connecting opposite 1/16 corners.

C. Description of monument for corner and accessories established to perpetuate locating the position of the corner:

(J6) Set 1"IDx36" I. pipe with 4" alum.  
MDNR cap. Blazed, scribed, and set  
measuring nails in:

4" Balsam S28W 0.85' "CS BT"

8" Spruce N28E 12.2' do

16" Tamarack N12W 20.55' do

6" twin Spruce N62E 16.2' do

Bearings are magnetic. Distances are to  
nail with tag.

(11) Set 1"IDx36" I. pipe w/plastic cap  
"MICH DNR PS 33986". Blazed, scribed  
and set measuring nails in:

5" Balsam N13W 3.8' "SW1/16 BT"

10" Spruce S69E 8.9' do

8" Balsam S55W 19.55' do

6" Balsam S14W 5.05' do

Set cedar post adjacent. Bearings are  
magnetic. Distances are to nail with  
tag.

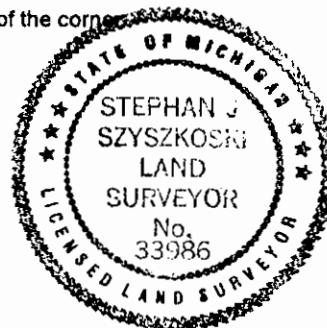

Signed by Stephan J. Szyszkoski  
Surveyor's Michigan License No. 33986

Date 7/29/03

For the Michigan Department of Natural Resources - Office of Land and Facilities

FORM APPROVED BY MICHIGAN STATE BOARD OF PROFESSIONAL SURVEYORS, JAN. 28, 1971  
REVISED MAY 14, 1975  
REVISED JAN., 1983  
REVISED OCT., 1995