

MAY 22 2000

\$7.00  
\$2.00

KENT COUNTY REMONUMENTATION

SECTION

LAND CORNER RECORDATION CERTIFICATE  
Filing Requirement of Act 74, Mich. P.A. 1970

For corners in

KENT COUNTY  
(County)

Located In:

Corner Code #

1. Public Land Survey

T\_\_\_ R\_\_\_  
T\_\_\_ R\_\_\_  
T\_\_\_ R\_\_\_  
T\_\_\_ R\_\_\_

2. Property Controlling  
in Section

S\_\_\_4 T\_\_\_10N R\_\_\_11W

Wit. Mon. on

3. Miscellaneous  
Property in Sec.

S\_\_\_ T\_\_\_ R\_\_\_  
S\_\_\_ T\_\_\_ R\_\_\_

N. Sec. (Twp.) Line

Solon Twp.

4. Lot No. \_\_\_\_\_, Recorded Plat \_\_\_\_\_

5. Private Claims \_\_\_\_\_

I, Kirk Breitels, in a field survey on June 10, 19 99 do hereby state that under requirements of P.A. 74, Michigan P.A. of 1970, the corner points mentioned in lines 1 and 2 above were in conformance with regulations and rules therefore as required in the current manual of survey instructions of the United States Department of the Interior, Bureau of Land Management or by a decree of a Court of Law and/or that the corner points mentioned in lines 3, 4 and 5 above were in conformance with the rules of the Michigan Board of Land Surveyors or by a Decree of a Court of Law; established, re-established, monumented, recovered, found as expressed below:

NOTE: Not more than 2 corners, all in the same town and range, may be recorded on this certificate.

A. Description of original monument and accessories and/or subsequent restoration:

1837	GLO	Cathcart	Not Set
1993	LCRC #6804	W. Glaza	Set Kent Co. Witness Monuement on Sec. (Twp.) Line 40' East of waters edge of Gilbert Lake.

The position of this corner was previously approved by the Kent County Remonumentation Peer Group, as monumented by Wallace E. Glaza on 8-9-93 and was recorded per LCRC #6804

B. Description of corner evidence found and/or method applied in restoring or reestablishing corner:

Found Kent Co. Witness Monument per witnesses of above LCRC as set by Wallace C. Glaza.

Nail & KC Remon. tag S. side 8" Oak	N60°W 34.09'
Nail & KC Remon. tag E. side 30" Pine	N40°E 43.54'
Nail & KC Remon. tag N. side 20" Oak	N90°W 18.50'
Nail & KC Remon. tag W. side 8" Birch	S20°E 14.65'
In East-West fence line	

P.A. 345 1990 KENT COUNTY

PEER APPROVED 6/24/99

CHAIRMAN Henry Huber

The above location is accepted by me and is generally accepted by professional surveyors as the best available evidence of the position of the Witness Corner.

C. Description of monument for corner and accessories established to perpetuate locating the position of the corner:

Kent County Witness Monument

Nail & KC Remon. tag E. side 32" Pine	N40°E 43.56'
Nail & KC Remon. tag N. side 22" Oak	N90°E 18.20'
Nail & KC Remon. tag W. side 10" Birch	S20°E 14.65'
Nail & KC Remon. tag S. side 12" Oak	S80°W 15.71'
In East-West fence line	
East edge of Gilbert Lake is West 50' ±	

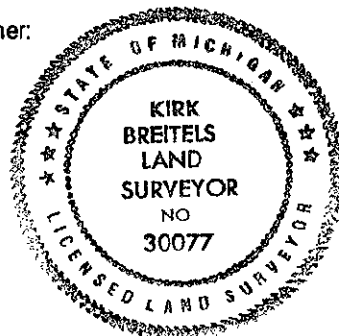

Signed by Kirk Breitels

Date 6/24/99

Surveyor's Michigan License No. 30077