

MAY 22 2000

KENT COUNTY REMONUMENTATION

SECTION

LAND CORNER RECORDATION CERTIFICATE  
Filing Requirement of Act 74, Mich. P.A. 1970

Sec 2  
"other" corner #4

REG. OF DEEDS

STATE OF MICHIGAN  
COUNTY OF KENT  
RECEIVED FOR RECORD  
1999 JUL -9 AM 11:19

11238

Register of Deeds Stamp & File Number

For corners in

KENT COUNTY

(County)

Located In:

Corner Code #

1. Public Land Survey

T R  
T R  
T R  
T R

2. Property Controlling  
in Section

S 2 T 10 N R 11 W

Wit. Mon. on  
S. Sec. Line

3. Miscellaneous  
Property in Sec.

S T R  
S T R

4. Lot No. , Recorded Plat

5. Private Claims

I, Kirk Breitels, in a field survey on June 1, 19 99 do hereby state that under requirements of P.A. 74, Michigan P.A. of 1970, the corner points mentioned in lines 1 and 2 above were in conformance with regulations and rules therefore as required in the current manual of survey instructions of the United States Department of the Interior, Bureau of Land Management or by a decree of a Court of Law and /or that the corner points mentioned in lines 3, 4 and 5 above were in conformance with the rules of the Michigan Board of Land Surveyors or by a Decree of a Court of Law; established, re-established, monumented, recovered, found as expressed below:

NOTE: Not more than 2 corners, all in the same town and range, may be recorded on this certificate.

A	B	C	D	E	F	G	H	I	J	K	L	M
1												
2	6		5		4		3		2		1	
3												
4	7		8		9		10		11		12	
5												
6	18		17		16		15		14		13	
7												
8	19		20		21		22		23		24	
9												
10	30		29		28		27		26		25	
11												
12	31		32		33		34		35		36	
13												

A. Description of original monument and accessories and/or subsequent restoration:

1837 GLO Cathcart Not Set  
1993 LCRC #6806 W. Glaza Set Kent Co. Witness Monuement on Sec. Line 1866.94' East of SW corner of Sec. 2

The position of this corner was previously approved by the Kent County Remonumentation Peer Group, as monumented by Wallace E. Glaza on 8-17-93 and was recorded per LCRC #6806

B. Description of corner evidence found and/or method applied in restoring or reestablishing corner:

Found Kent Co. Witness Monument per witnesses of above LCRC as set by Wallace E. Glaza.

Nail & KC Remon. tag SE side 8" Tree N10°E 44.69'  
Nail & KC Remon. tag SE side 8" Birch N29°E 25.84'  
Nail & KC Remon. tag N. side 14" Tree S15°W 8.03'  
Nail & KC Remon. tag SW side 16" Tree S57°E 21.48'  
Nail & KC Remon. tag N. side 18" Maple S87°W 21.99'  
East-West wire fence is South 1'

P.A. 345 1990 KENT COUNTY

PEER APPROVED 6/24/99

CHAIRMAN

The above location is accepted by me and is generally accepted by professional surveyors as the best available evidence of the position of the Witness Corner.

C. Description of monument for corner and accessories established to perpetuate locating the position of the corner:

Kent County Witness Monument

Nail & KC Remon. tag SE side 10" Poplar N10°E 44.72'  
Nail & KC Remon. tag SE side 8" stump N29°E 25.76'  
Nail & KC Remon. tag N. side 14" Maple S75°E 8.05'  
Nail & KC Remon. tag SW side 18" Maple S57°E 21.48'  
Nail & KC Remon. tag N. side 20" Maple S87°W 21.95'  
East-West wire fence is South 1'

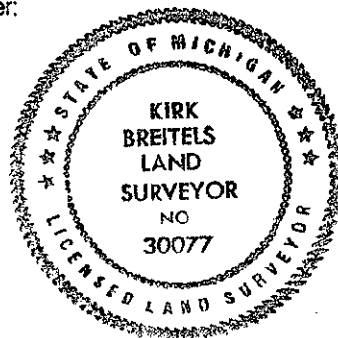

Signed by Kirk Breitels

Date 6/24/99

Surveyor's Michigan License No. 30077