

MAY 22 2000

KENT COUNTY REMONUMENTATION

SECTION

LAND CORNER RECORDATION CERTIFICATE
Filing Requirement of Act 74, Mich. P.A. 1970

Seg 2
"other" corner #7

\$7.00
\$2.00

For corners in

KENT COUNTY
(County)

Located in:

Corner Code #

1. Public Land Survey

T___ R___
T___ R___
T___ R___
T___ R___

2. Property Controlling
in Section

S___ T___ R___
S___ T___ R___
S___ T___ R___

3. Miscellaneous
Property in Sec.

S___ T___ R___
S___ T___ R___
S___ T___ R___

REC. OF DEEDS

STATE OF MICHIGAN
COUNTY OF KENT
RECEIVED FOR RECORD
1999 JUL - 9 AM 11:19

11235

Register of Deeds Stamp & File Number

4. Lot No. _____, Recorded Plat _____
5. Private Claims _____

I, Kirk Breitels, in a field survey on June 1, 19 99 do hereby state that under requirements of P.A. 74, Michigan P.A. of 1970, the corner points mentioned in lines 1 and 2 above were in conformance with regulations and rules therefore as required in the current manual of survey instructions of the United States Department of the Interior, Bureau of Land Management or by a decree of a Court of Law and /or that the corner points mentioned in lines 3, 4 and 5 above were in conformance with the rules of the Michigan Board of Land Surveyors or by a Decree of a Court of Law; established, re-established, monumented, recovered, found as expressed below:

NOTE: Not more than 2 corners, all in the same town and range, may be recorded on this certificate.

	A	B	C	D	E	F	G	H	I	J	K	L	M
1													
2	6		5		4		3		2		1		
3													
4	7		8		9		10		11		12		
5													
6	18		17		16		15		14		13		
7													
8	19		20		21		22		23		24		
9													
10	30		29		28		27		26		25		
11													
12	31		32		33		34		35		36		
13													

A. Description of original monument and accessories and/or subsequent restoration:

1837 GLO Cathcart Not Set
1993 LCRC #6809 W. Glaza Set Kent Co. Witness Monuement on Sec. Line 2026.10' West of SE corner of Sec. 2

The position of this corner was previously approved by the Kent County Remonumentation Peer Group, as monumented by Wallace E. Glaza on 8-17-93 and was recorded per LCRC #6809

B. Description of corner evidence found and/or method applied in restoring or reestablishing corner:

Found Kent Co. Witness Monument per witnesses of above LCRC as set by Wallace E. Glaza.

Nail & KC Remon. tag NW side 8" Oak S65°W 13.99'
Nail & KC Remon. tag SW side 14" Oak N38°W 10.79'
Nail & KC Remon. tag SE side 24" Maple N38°E 49.52'
Nail & KC Remon. tag N. side 24" Maple N79°E 51.03'
Nail & KC Remon. tag W. side 36" Oak S25°E 52.62'

P.A. 345 1990 KENT COUNTY

PEER APPROVED 6/24/99

CHAIRMAN *[Signature]*

Centerline of 2 track is South 160' ±

The above location is accepted by me and is generally accepted by professional surveyors as the best available evidence of the position of the Witness Corner.

C. Description of monument for corner and accessories established to perpetuate locating the position of the corner:

Kent County Witness Monument

Nail & KC Remon. tag NW side 10" Oak S65°W 14.02'
Nail & KC Remon. tag SW side 16" Oak N38°W 10.77'
Nail & KC Remon. tag SE side 26" Maple N38°E 49.52'
Nail & KC Remon. tag N. side 26" Maple N79°E 51.03'
Nail & KC Remon. tag W. side 40" Oak S25°E 52.71'
East-West fence is 6' South

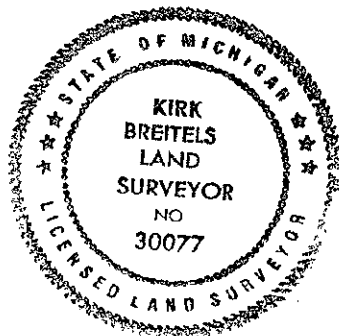

Signed by *[Signature]*
Surveyor's Michigan License No. 30077

Date 6/24/99