

FEB 25 1999

9-

FILED

SECTION

LAND CORNER RECORDATION CERTIFICATE

Filing Requirement of Act 74, Mich. P.A. 1970

1998 OCT 27 P 2: 22

For corners in

Livingston (County)

Located In:

Corner Code //

- 1. Public Land Survey T 1N R 6E I-5
T _____ R _____
T _____ R _____
T _____ R _____
- 2. Property Controlling S _____ T _____ R _____
in Section S _____ T _____ R _____
- 3. Miscellaneous S _____ T _____ R _____
Property in Sec. S _____ T _____ R _____

NANCY HAVILAND REGISTER OF DEEDS LIVINGSTON COUNTY, MI. 48843

LSC968M

Register of Deeds Stamp & File Number

- 4. Lot No. _____, Recorded Plat _____
- 5. Private Claims _____

I, Bryan L. Boss, in a field survey on September 28, 1998, do hereby certify that under requirements of P.A. 74, Michigan P.A. of 1970, the corner points mentioned in lines 1 and 2 above were in conformance with regulations and rules therefore as required in the current manual of survey instructions of the United States Department of the Interior, Bureau of Land Management or by a decree of a Court of Law and/or that the corner points mentioned in lines 3, 4 and 5 above were in conformance with the rules of the Michigan Board of Land Surveyors or by a Decree of a Court of Law; established, re-established, monumented, re-monumented, recovered, found as expressed below:

NOTE: Not more than 4 corners, all in the same town and range, may be recorded on this certificate.

A. Description of original monument and accessories and/or subsequent restoration:

- Black Oak 20" N 71 E 46 links
- Black Oak 24" S 86 W 1.42 chains

B. Description of corner evidence found and/or method applied in restoring or reestablishing corner:

Found $\frac{1}{2}$ " iron rod inside $1\frac{1}{4}$ iron pipe, ^(3.5) 35 feet South of the Centerline of Silver Lake Rd.

P.A. 345 1990, APPROVED BY LIVINGSTON COUNTY PEER GROUP ON 9-2-98 CO. REP JED

C. Description of monument for corner and accessories established to perpetuate locating the position of the corner:

- Set $1\frac{1}{4}$ " by 30" pipe with 6" breakaway with Brass cap stamped "Livingston County Monumentation Corner"
- N 80 E 83.74 N/T Northside 20" Hickory
- S 50 E 67.44 N/T Southwest side P.Pole
- N 36 W 52.32 N/T Westside 20" Oak
- S 60 W 59.13 Southeast side 12" Ash

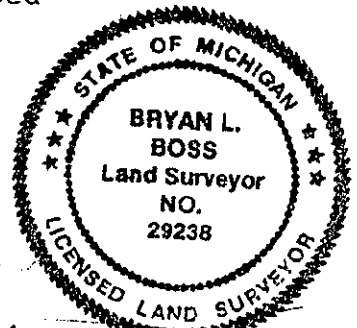

Signed by Bryan L. Boss

Date 10-14-1998

Surveyor's Michigan License No. 29238

