

MICHIGAN
DEPARTMENT OF CONSERVATION
FORESTRY DIVISION

LAND CORNER RECORD

T. 42-43 N.R. 7-8 W

Mackinac COUNTY

DESCRIPTION OF CORNER Section Corner common to Secs. 1-6-31-36 also a Township Corner

CORNER MONUMENT 1" Pipe with 4" Aluminum Cap

DATE MONUMENT PLACED AND WITNESSED 11/6/63 with Ed Eckart, Ass't. Forester

WITNESSES TO CORNER..... 7" Cedar (S1 NBT), S 77° W, 25 Lks.

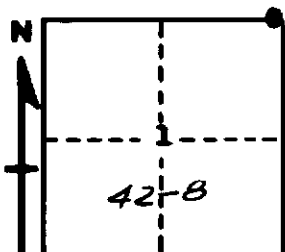

6" Cedar (S36 NBT), N 37° W, 41½ Lks.

7" Cedar (S31 NBT), N 08° E, 34½ Lks.

AND

CIRCLE CORNER REGISTERED

DESCRIPTION IN DETAIL AS TO HOW CORNER WAS LOCATED AND IDENTIFIED OR RESTORED.

This Corner was replaced at Wood Post set by Marcus Schaaf, Registered Land Surveyor. Found Cedar N.T. bearing S 77° W, 12 Lks. in fair condition.

SURVEYOR'S SEAL

SIGNED Billy D. Buckler
Billy D. Buckler
REGISTERED LAND SURVEYOR

DATE 10/19/1964